

**Bristol Forestville**  
**Bristol, CT**  
**FF and E Specifications by Item**

**General Notes :**

1. All file cabinets require counter balances.
2. Locking files are to be keyed alike by room. Provide 3 Master Keys to Principal.
3. All Upholstery Fabrics shall have Stain Resistant Finish.
4. Provide & install all necessary hardware for all bookcases, library stacks, metal shelving, gym equipment and other items for safe & secure installation and proper function.
5. Verify in field for correct dimension and location for library shelving.
6. In the event of a discrepancy between the Unit Cost and the Total Cost, the Unit Cost shall prevail.
7. Deliveries shall have the use of the loading dock and the elevator.

**Code Compliance Notes:**

In order to meet the needs of persons with disabilities, when applicable all items shall comply with the current Connecticut Basic Building Code including 2003 ICC/ANSI A177.1, Section 504 Rehabilitation Act 1973 including the Uniform Federal Accessibility Standards (UFAS) and 504 Regulations, and Americans With Disabilities Act Title II including Americans with Disabilities Act (ADAAG) and ADA Regulations.

Accessible Knee Clearance shall be a minimum of: 30"W, 27"H (24"H Child), and 19" Deep.

Compliance with the current Connecticut Fire Safety Code and current O.S.H.A. - Title 29/Labor is also required when applicable.

The "Items" shall include, but are not limited to Fixtures, Furnishings, Equipment, Workstations, (Including Built-ins), Playground Equipment, Laboratory Fume Hoods, Darkroom Equipment, Welding Stations, Shop Equipment, etc.

**Bristol Forestville**  
**Bristol, CT**  
**FF and E Specifications by Item**

**Item:** Paper Roll Cutter Rack

**Item Code:** A-1

**Manufacturer:** Rola-Rack

**Total Quantity:** 2

**Model:** DickBlick #12910-0000

**Category:** D

**Description:** Paper Roll Rack - A deluxe paper rack for 36" wide rolls only. It's constructed of welded and formed steel for a lifetime of service. It holds 8 rolls, and has self-adjusting blade paper cutters and heavy-duty casters.

**Dimensions:** 38"Wx25"Dx53"H

**Finish:** Color: Grey

**Power / Data:**



Room #	Room Name	Qty
121	ELEMENTARY ART ROOM	1

Room #	Room Name	Qty
245A	ART STORAGE	1

Room #	Room Name	Qty
--------	-----------	-----

# Bristol Forestville

## Bristol, CT

### FF and E Specifications by Item

**Item:** Metal Drying Rack

**Item Code:** A-2

**Manufacturer:** Saturn

**Total Quantity:** 2

**Model:** DickBlick #51315-1007

**Category:** D

**Description:** Drying Rack with Small Mesh Openings - flip racks have 50 non-warping metal trays with patented, non-locking rubber feet. The racks are supported by a reinforced steel framework, and move easily on ball-bearing casters.



**Dimensions:** Floor Space: 48.5"Wx37"Dx62-86"H  
50 Trays: 48"Wx32"D  
Mesh Openings: 4"x4.5"

**Finish:** Finish: Std

**Power / Data:**

Room #	Room Name	Qty
121	ELEMENTARY ART ROOM	1

Room #	Room Name	Qty
245A	ART STORAGE	1

Room #	Room Name	Qty
--------	-----------	-----

**Bristol Forestville**  
**Bristol, CT**  
**FF and E Specifications by Item**

**Item:** Table Trimmer

**Item Code:** A-3

**Manufacturer:** GBC - Classiccut Ingento

**Total Quantity:** 2

**Model:** DickBlick #57107-1005

**Category:** D

**Description:** Paper Cutter / Table Trimmer without hold down bar. Table trimmer includes heavy-duty cutting assembly mounted on a sturdy wooden table with a drop shelf and a storage shelf below.



**Dimensions:** 30"Wx30"D

**Finish:** Finish: Maple

**Power / Data:**

Room #	Room Name	Qty
121	ELEMENTARY ART ROOM	1

Room #	Room Name	Qty
245	MIDDLE SCHOOL ART ROOM	1

Room #	Room Name	Qty
--------	-----------	-----

**Bristol Forestville**  
**Bristol, CT**  
**FF and E Specifications by Item**

**Item:** Heat-Proof Kiln Cart

**Item Code:** A-5

**Manufacturer:** Debcor

**Total Quantity:** 2

**Model:** DickBlick #30219-1005

**Category:** D

**Description:** Heat Proof Kiln Cart - mobile, sturdy heavy-gauge steel kiln cart includes 3 heat-proof, non-aesbestos, heat resistant panels that fit the inside trays. Capacity 150LBS/shelf. Wheels are 4"d. With 2 swivel casters.

**Dimensions:** 24"Wx36"Lx32"H

**Finish:** Color: Grey

**Power / Data:**



Room #	Room Name	Qty
121B	ART STORAGE	1

Room #	Room Name	Qty
245A	ART STORAGE	1

Room #	Room Name	Qty
--------	-----------	-----

**Bristol Forestville**  
**Bristol, CT**  
**FF and E Specifications by Item**

**Item:** Brent Ware Cart **Item Code:** A-6  
**Manufacturer:** Brent Ware **Total Quantity:** 2  
**Model:** DickBlick #30205-1008 & 30205-1009 **Category:** D  
**Description:** Brentware Cart w/shelves - heavy-duty, steel-frame cart constructed from one-inch heavy-wall pipe & ½" exterior grade plywood shelves -set of 12.  
**Dimensions:** 35"Wx24"Dx72.75"H  
**Finish:** Finish: Steel & Plywood  
**Power / Data:**



Room #	Room Name	Qty
121B	ART STORAGE	1

Room #	Room Name	Qty
245A	ART STORAGE	1

Room #	Room Name	Qty
--------	-----------	-----

# Bristol Forestville

## Bristol, CT

### FF and E Specifications by Item

**Item:** Art Easel

**Item Code:** A-8

**Manufacturer:** Test Rite #1450

**Total Quantity:** 2

**Model:** DickBlick #50235-0000

**Category:** D

**Description:** Test Rite Superior Studio Easel - Aluminum combines strength and durability in a lightweight easel. The easel's simple A-frame geometry supports a lot of canvas for its size and weight, canvases up to 86" high when canvas supports are adjusted to full vertical extension. The easel also has an inclinable center section for tilting canvases forward up to 30°



**Dimensions:** 24"Wx90"H

**Finish:** Finish: Aluminum

**Power / Data:**

Room #	Room Name	Qty
121	ELEMENTARY ART ROOM	1

Room #	Room Name	Qty
245A	ART STORAGE	1

Room #	Room Name	Qty
--------	-----------	-----

**Bristol Forestville**  
**Bristol, CT**  
**FF and E Specifications by Item**

**Item:** Area Rug **Item Code:** AR-0

**Manufacturer:** Joy Carpets **Total Quantity:** 6

**Model:** School Specialty #6-1355908-258 **Category:** D

**Description:** Kindergarten - Joy Carpet - Retangular Rainbow Alphabet Rug  
 Made of 100% STAINMASTER nylon cut pile with Polypropylene backing.  
 Rug has antimicrobial and static protection. It is Green Label Plus Certified  
 with the Highest Indoor Air Quality Standard. It also has Lotus FX Fiber Shield  
 Soil & Stain Protection & Class I Flammability Rating.



**Dimensions:** 7'-8"x10'-9"

**Finish:** Color: Blue Field with Rainbow Border and Letters

**Power / Data:**

Room #	Room Name	Qty
123	CLASSROOM	1
126	CLASSROOM	1

Room #	Room Name	Qty
124	CLASSROOM	1
127	CLASSROOM	1

Room #	Room Name	Qty
125	CLASSROOM	1
219	ES SPECIAL ED	1

**Bristol Forestville**  
**Bristol, CT**  
**FF and E Specifications by Item**

**Item:** Area Rug **Item Code:** AR-1  
**Manufacturer:** Carpets for Kids **Total Quantity:** 5  
**Model:** School Specialty #6-679223-258 **Category:** D  
**Description:** 1st Grade - Carpets for Kids - Colorful Places Seating Rectangular Rug  
**Dimensions:** 7'-6"x12' Rectangle  
**Finish:** Color: Multicolor  
**Power / Data:**



Room #	Room Name	Qty
135	CLASSROOM	1
138	CLASSROOM	1

Room #	Room Name	Qty
136	CLASSROOM	1
139	CLASSROOM	1

Room #	Room Name	Qty
137	CLASSROOM	1

**Bristol Forestville**  
**Bristol, CT**  
**FF and E Specifications by Item**

**Item:** Area Rug **Item Code:** AR-7  
**Manufacturer:** Carpets for Kids **Total Quantity:** 1  
**Model:** School Specialty #6-078446-258 **Category:** D  
**Description:** Art Classroom -Carpets for Kids Bilingual Colors Oval Rug  
**Dimensions:** 6'-9"x9'-5" Oval  
**Finish:** Color: Multicolor  
**Power / Data:**



Room #	Room Name	Qty
121	ELEMENTARY ART ROOM	1

Room #	Room Name	Qty
--------	-----------	-----

Room #	Room Name	Qty
--------	-----------	-----

# Bristol Forestville

## Bristol, CT

### FF and E Specifications by Item

**Item:** Area Rug **Item Code:** AR-8

**Manufacturer:** Joy Carpets **Total Quantity:** 2

**Model:** School Specialty #6-1355910-258 **Category:** D

**Description:** Family Resource Room Area Rugs - Joy Carpets, Round Fabric: Stainmaster 100% nylon cut pile w/ Polypropylene back and antimicrobial & antistatic treatment. Green Label Plus Certified w/Highest Indoor Air Quality Standard, Lotus FX Fiber Shield Soil & Stain Protection, Class I Flammability Rating.

**Dimensions:** 7'-7" Diameter

**Finish:** Color: Multicolor

**Power / Data:**



Room #	Room Name	Qty
143	FAMILY RESOURCE ROOM	2

Room #	Room Name	Qty
--------	-----------	-----

Room #	Room Name	Qty
--------	-----------	-----

**Bristol Forestville**  
**Bristol, CT**  
**FF and E Specifications by Item**

**Item:** LCD Monitor Cart **Item Code:** AV-1  
**Manufacturer:** BUHL **Total Quantity:** 2  
**Model:** School Outfitters #BHL-PLCAB44E **Category:** D  
**Description:** Flat panel monitor and AV equipment cart w/ cabinet. Twin-post brackets hold monitors up to 52 inches securely in place. Slide-out side shelves keep laptops and projectors close at hand, and the lockable steel cabinet underneath. Rolls on 4 swivel casters (two locking).  
**Dimensions:** 32"Wx27.25"Dx44"H  
**Finish:** Color: Charcoal  
**Power / Data:** UL/CSA approved steel cart includes a 4-outlet surge-protected electrical assembly with a 20-foot cord and cord winder



Room #	Room Name	Qty
166	WORKROOM/ STORAGE	2

Room #	Room Name	Qty
--------	-----------	-----

Room #	Room Name	Qty
--------	-----------	-----

# Bristol Forestville

## Bristol, CT

### FF and E Specifications by Item

**Item:** Ripple Bench w/Wave Seat

**Item Code:** B-1

**Manufacturer:** Coalesse

**Total Quantity:** 7

**Model:** Ripple Bench 490-B96VRT

**Category:** A-2

**Description:** Upholstered bench, uniframe body with finger jointed plywood, multiple densities of laminated polyurethane foam, double needle stitch seams and height adj. leveling polyurethane glides with stainless steel finish.

**Dimensions:** 19 1/4"D x 97"W x 19 1/4"H

**Finish:**

**Lobby/Corridors:** Qty (4) Contrasting Fabric COM- Designtex Group Inc.  
Vinyl: Sorano 3403-504 "Chervil"

**Reception:** Qty (1) COM-Designtex Group Inc. Vinyl: Sorano 3403-505 "Aloe"  
Seat upholstery, Side/End/underside: Pallas, Jacks/Pacific Blue 27.128.074

**Media Center:** Qty (2) COM: Paul Brayton Designs Almost Matte AMT-773  
"Cinnabar"



**Power / Data:**

Room #	Room Name	Qty
100	MEDIA CENTER	2
C103	CORRIDOR	2

Room #	Room Name	Qty
106	RECEPTION	1

Room #	Room Name	Qty
C101	CORRIDOR	2

# Bristol Forestville

## Bristol, CT

### FF and E Specifications by Item

**Item:** Book Case - 3 Shelf

**Item Code:** BC-1

**Manufacturer:** KI

**Total Quantity:** 15

**Model:** 700 Series - Curve S7CB3639015

**Category:** L

**Description:** 700 Series - Curve, Three Shelf Metal Bookcase with 1 fixed and 2 adjustable shelves.

**Dimensions:** 36"Wx15"Dx 42 1/16"H

**Finish:** Powdercoat: Light Tone

**Power / Data:**



Room #	Room Name	Qty
131	SMALL GROUP	1
134	CUSTODIAN STORAGE	1
205	SMALL GROUP 5	1
253	SMALL GROUP 3	1

Room #	Room Name	Qty
132	SMALL GROUP	1
144	ELEMENTARY SCHOOL MUSIC	6
251	SMALL GROUP 1	1

Room #	Room Name	Qty
133	SMALL GROUP	1
204	SMALL GROUP 4	1
252	SMALL GROUP 2	1

**Bristol Forestville**  
**Bristol, CT**  
**FF and E Specifications by Item**

**Item:** Book Case - Fold-n-Lock

**Item Code:** BC-2

**Manufacturer:** Jonticraft

**Total Quantity:** 10

**Model:** 042710JC

**Category:** C-1

**Description:** E-Z Glide Fold - n - Lock - mobile bookcase w/ 25 clear cubbie trays and back option. Book case is constructed with dowel pin joints, folds on full length piano hinges and moves on bracket mounted casters concealed behind kickplates. All edges are fully rounded.



**Dimensions:** 48"Wx30"Dx35.5"H

**Finish:** Finish: KIDZTuff Birch  
 Bins: Clear  
 Back Option: Magnetic Write-n-Wipe

**Power / Data:**

Room #	Room Name	Qty
123	CLASSROOM	2
126	CLASSROOM	2

Room #	Room Name	Qty
124	CLASSROOM	2
127	CLASSROOM	2

Room #	Room Name	Qty
125	CLASSROOM	2

# Bristol Forestville

## Bristol, CT

### FF and E Specifications by Item

**Item:** Big Book Mobile Shelves & Easel

**Item Code:** BC-3

**Manufacturer:** Jonticraft

**Total Quantity:** 5

**Model:** 0543JC

**Category:** C-1

**Description:** Big-Book Mobile Easel w/Magnetic Write-n-Wipe - Folding display easel with storage compartment for markers, magnetic letters & supplies. 6 Vertical partitioned storage compartments for big books in the back. Kickplate conceals casters w/caster brackets when stationary.

**Dimensions:** 24-1/2"Wx15"Dx30"H 43"H w/Easel Open

**Finish:** Finish: KIDZTuff Birch  
Front: Magnetic Write & Wipe  
Bins: Clear



**Power / Data:**

Room #	Room Name	Qty
123	CLASSROOM	1
126	CLASSROOM	1

Room #	Room Name	Qty
124	CLASSROOM	1
127	CLASSROOM	1

Room #	Room Name	Qty
125	CLASSROOM	1

# Bristol Forestville

## Bristol, CT

### FF and E Specifications by Item

---

**Item:** Book Case

**Item Code:** BC-5

**Manufacturer:** Jonticraft

**Total Quantity:** 2

**Model:** 06210JC

**Category:** C-1

**Description:** Mobile Storage Cubbies w/20 Clear Bins. Concealed casters on metal caster brackets.

**Dimensions:** 38.5"Wx15"Dx35.5"H

**Finish:** Finish: KIDZTuff Birch  
Bins: Clear



**Power / Data:**

Room #	Room Name	Qty
143	FAMILY RESOURCE ROOM	2

Room #	Room Name	Qty
--------	-----------	-----

Room #	Room Name	Qty
--------	-----------	-----

# Bristol Forestville

## Bristol, CT

### FF and E Specifications by Item

**Item:** Book Case

**Item Code:** BC-6

**Manufacturer:** Jonticraft

**Total Quantity:** 1

**Model:** 0269JC

**Category:** C-1

**Description:** Mobile Storage Book Case with fixed divided shelves and concealed casters on metal caster brackets.

**Dimensions:** 36"Wx15"Dx35.5"H

**Finish:** Finish: KidzTuff Birch

**Power / Data:**



Room #	Room Name	Qty
143	FAMILY RESOURCE ROOM	1

Room #	Room Name	Qty
--------	-----------	-----

Room #	Room Name	Qty
--------	-----------	-----

**Bristol Forestville**  
**Bristol, CT**  
**FF and E Specifications by Item**

**Item:** Book Case **Item Code:** BC-7  
**Manufacturer:** Jonticraft **Total Quantity:** 4  
**Model:** 0769JC **Category:** C-1  
**Description:** Mobile Book Case, with 2 adjustable shelves. Concealed casters on metal  
 caster brackets.  
  
**Dimensions:** 48"Wx15"Dx35.5"H  
**Finish:** Finish: KidzTuff Birch  
**Power / Data:**



Room #	Room Name	Qty
143	FAMILY RESOURCE ROOM	4

Room #	Room Name	Qty
--------	-----------	-----

Room #	Room Name	Qty
--------	-----------	-----

**Bristol Forestville**  
**Bristol, CT**  
**FF and E Specifications by Item**

**Item:** Book Display - Revolver **Item Code:** BD-1  
**Manufacturer:** R-Wireworks **Total Quantity:** 7  
**Model:** School Specialty #6-644749-030 **Category:** D  
**Description:** Paperback Book Revolver with noiseless operation, and face-out display.  
 Pocket size fits paperback books with maximum book height 7-1/4".  
  
**Dimensions:** 15.25"Wx15.25"Dx60.5"H  
 Turns in 22" Space.  
  
**Finish:** Color: Black  
  
**Power / Data:**



Room #	Room Name	Qty
160	CLASSROOM	1
250	CLASSROOM	1
309	CLASSROOM	1

Room #	Room Name	Qty
161	CLASSROOM	1
254	WORLD LANGUAGE	1

Room #	Room Name	Qty
248	CLASSROOM	1
308	CLASSROOM	1

# Bristol Forestville

## Bristol, CT

### FF and E Specifications by Item

**Item:** Book Display - Mobile

**Item Code:** BD-2

**Manufacturer:** Jonticraft

**Total Quantity:** 1

**Model:** 3507JC

**Category:** C-1

**Description:** 2 sided Mobile Pick-a-Book Stand - on locking casters. Back is identical to front with equal storage capacity. Eight 1" shelves.

**Dimensions:** 30"Wx16.5"Dx30"H

**Finish:** Finish: KidzTuff Birch  
Dividers: Magnetic Write & Wipe

**Power / Data:**



Room #	Room Name	Qty
143	FAMILY RESOURCE ROOM	1

Room #	Room Name	Qty
--------	-----------	-----

Room #	Room Name	Qty
--------	-----------	-----

# Bristol Forestville

## Bristol, CT

### FF and E Specifications by Item

**Item:** Ergonomic Task Chair **Item Code:** C-1

**Manufacturer:** Humanscale **Total Quantity:** 14

**Model:** W11GT13W \_\_\_\_ - Diffrient World **Category:** C-2

**Description:** Administrative - Fully Ergonomic Task Chair with adjustable height Duron arms, seat pan depth. 15 year Warranty for 24/7 use, mechanism, fabric/cushions/armrest 5 year warranty 97% Recyclable Parts.

**Dimensions:** 26"Wx24"Dx36.5-41.5"H  
16.5-20" Seat Height

**Finish:** Frame: Grey w/Stainless Steel Caps on Legs  
Arms: Grey, Mesh: Torque, Aluminum T13  
Upholstery: Media Center Qty (2) Pattern: Wave, Color: Cayenne W803.  
Admin Qty (12) Pattern: Wave, Color: Navy 507  
**Media Center Qty (3) Wave "Cayenne" W803**  
**Admin Offices: Qty (11) Wave "Navy" 507**



**Power / Data:**

Room #	Room Name	Qty
100A	CIRCULATION	2
103	PSYCH.	1
109	PRINCIPAL	1
167	OFFICE	1

Room #	Room Name	Qty
100C	LITERACY	1
104	PSYCH.	1
111	AP	1
107	ADMINISTRATION	3

Room #	Room Name	Qty
101	ASSISTANT COUNCELOR	1
105	GUIDANCE COUNCELOR	1
112	AP	1

# Bristol Forestville

## Bristol, CT

### FF and E Specifications by Item

---

**Item:** Lounge Chair **Item Code:** C-10

**Manufacturer:** Steelcase - Turnstone **Total Quantity:** 4

**Model:** Jenny Chair TS31408 **Category:** A-2

**Description:** Fully upholstered lounge chair with maple wood feet and arms.

**Dimensions:** 32.5"Wx32.5"Dx32.5"H  
16" Seat Height

**Finish:** Arms & Feet: Maple with Clear Maple Finish  
Upholstery: Steelcase Seating Vinyl #5812 Navy Fabric group 1



**Power / Data:**

Room #	Room Name	Qty
106	RECEPTION	4

Room #	Room Name	Qty
--------	-----------	-----

Room #	Room Name	Qty
--------	-----------	-----

**Bristol Forestville**  
**Bristol, CT**  
**FF and E Specifications by Item**

**Item:** Lounge Chair **Item Code:** C-11  
**Manufacturer:** Steelcase - Turnstone **Total Quantity:** 4  
**Model:** Jenny Chair TS31401 **Category:** A-2  
**Description:** Armless, fully upholstered lounge chair with maple wood feet.  
.  
**Dimensions:** 28.5"Wx32.5"Dx32.25"H  
16" Seat Height  
**Finish:** Feet: Maple with Clear Maple Finish  
Upholstery: Multiple upholstery: **Seat:** Steelcase Seating Vinyl Navy 5812  
**Inner Back:** Steelcase Buzz2 Celery 5F12  
**Outer Back:** Steelcase Buzz2 5F06 Sky.



**Power / Data:**

Room #	Room Name	Qty
143	FAMILY RESOURCE ROOM	4

Room #	Room Name	Qty
--------	-----------	-----

Room #	Room Name	Qty
--------	-----------	-----

**Bristol Forestville**  
**Bristol, CT**  
**FF and E Specifications by Item**

**Item:** Stool-Star Base - Adjustable Height

**Item Code:** C-12

**Manufacturer:** VS

**Total Quantity:** 4

**Model:** Panto Move-LuPo Plus

**Category:** C-2

**Description:** Five-star foot chair w/ gas-spring height adjustment and swivel. Textured polypropylene seat shell w/grip hole, double-walled construction with air-cushion effect and castors for hard flooring.

**Dimensions:** 17"Wx16 1/2"Dx18 1/2"-26 3/8"Seat Height

**Finish:** Frame: M059 Arctic  
Shell: C 029 Dark Blue



**Power / Data:**

Room #	Room Name	Qty
121	ELEMENTARY ART ROOM	1

Room #	Room Name	Qty
234	KITCHEN	2

Room #	Room Name	Qty
245	MIDDLE SCHOOL ART ROOM	1

# Bristol Forestville

## Bristol, CT

### FF and E Specifications by Item

**Item:** Student Chair

**Item Code:** C-13

**Manufacturer:** VS

**Total Quantity:** 313

**Model:** Panto Swing-LuPo

**Category:** C-2

**Description:** Stacking, forward-flexing, cantilever chair w/one piece bent round steel tube base, cross bar support and non-marring 2K glides. Textured polypropylene seat shell w/grip hole, double-walled construction with air-cushion effect and consealed seat attachments.

**Dimensions:** 12 5/8"WX11"Dx13 3/4" Seat Height

**Finish:** Frame: M059 Arctic  
Shell: C 029 Dark Blue



**Power / Data:**

Room #	Room Name	Qty
123	CLASSROOM	29
126	CLASSROOM	29
136	CLASSROOM	34
139	CLASSROOM	34

Room #	Room Name	Qty
124	CLASSROOM	29
127	CLASSROOM	29
137	CLASSROOM	34

Room #	Room Name	Qty
125	CLASSROOM	29
135	CLASSROOM	34
138	CLASSROOM	32

# Bristol Forestville

## Bristol, CT

### FF and E Specifications by Item

**Item:** Student Chair

**Item Code:** C-15

**Manufacturer:** VS

**Total Quantity:** 451

**Model:** Panto Swing-LuPo

**Category:** C-2

**Description:** Stacking, forward-flexing cantilever chair w/one-piece bent round steel tube base, cross bar support and non-marring 2K glides. Textured polypropylene seat shell w/grip hole, double-walled construction with air-cushion effect and concealed seat attachments.

**Dimensions:** 14 5/8"Wx14 1/4"Dx15" Seat Height

**Finish:** Frame: M059 Arctic  
Shell: C 029 Dark Blue



**Power / Data:**

Room #	Room Name	Qty
116A	ES ISS	4
125	CLASSROOM	5
130	OT/PT	1
133	SMALL GROUP	5
137	CLASSROOM	5
144	ELEMENTARY SCHOOL MUSIC	26
223	CLASSROOM	37
226	CLASSROOM	37
229	CLASSROOM	36

Room #	Room Name	Qty
123	CLASSROOM	5
126	CLASSROOM	5
131	SMALL GROUP	5
135	CLASSROOM	5
138	CLASSROOM	5
219	ES SPECIAL ED	26
224	CLASSROOM	37
227	CLASSROOM	36
231	CLASSROOM	36

Room #	Room Name	Qty
124	CLASSROOM	5
127	CLASSROOM	5
132	SMALL GROUP	5
136	CLASSROOM	5
139	CLASSROOM	5
221	CLASSROOM	37
225	CLASSROOM	37
228	CLASSROOM	36

# Bristol Forestville

## Bristol, CT

### FF and E Specifications by Item

**Item:** Student Chair **Item Code:** C-15F

**Manufacturer:** VS **Total Quantity:** 31

**Model:** Panto Swing-VF **Category:** C-2

**Description:** Stacking forward-flexing cantilever chair w/one-piece bent round steel tube base, cross bar support and universal glides. Beech plywood seat shell w/anti-slip finish, grip hole and concealed seat attachments .

**Dimensions:** 14 5/8"Wx14 1/4"Dx 15" Seat Height

**Finish:** Frame: M059 Arctic  
Seat & Back: H010 Natural



**Power / Data:**

Room #	Room Name	Qty
100	MEDIA CENTER	28

Room #	Room Name	Qty
163	WAITING	3

Room #	Room Name	Qty
--------	-----------	-----

# Bristol Forestville

## Bristol, CT

### FF and E Specifications by Item

**Item:** Student Chair

**Item Code:** C-17

**Manufacturer:** VS

**Total Quantity:** 985

**Model:** Panto Swing-LuPo Comfort Shell

**Category:** C-2

**Description:** Stacking, forward-flexing cantilever chair w/one-piece bent round steel tube base, cross bar support and non-marring 2K glides. Textured polypropylene seat shell w/grip hole, double-walled construction with air-cushion effect and concealed seat attachments.

**Dimensions:** 17"Wx16 1/2"Dx 17" Seat Height  
Comfort Size Shell

**Finish:** Frame: M059 Arctic  
Shell: C 029 Dark Blue



**Power / Data:**

Room #	Room Name	Qty
116B	MS ISS	4
148E	OFFICE	1
157	HEALTH	28
161	CLASSROOM	36
205	SMALL GROUP 5	5
211	CLASSROOM	36
214	CLASSROOM	36
217	CLASSROOM	36
241	CLASSROOM	36
250	CLASSROOM	36
253	SMALL GROUP 3	5
303	CLASSROOM	36
309	CLASSROOM	36

Room #	Room Name	Qty
143	FAMILY RESOURCE ROOM	16
153	CLASSROOM	5
158	CLASSROOM	28
201	MS SPECIAL ED	26
207	ES SCIENCE	28
212	CLASSROOM	36
215	CLASSROOM	36
238A	ENGINEERING COMPUTER LAB	26
246	CLASSROOM	28
251	SMALL GROUP 1	5
254	WORLD LANGUAGE	36
306	CLASSROOM	28
219	ES SPECIAL ED	5

Room #	Room Name	Qty
148C	OFFICE	1
154	CLASSROOM	36
160	CLASSROOM	36
204	SMALL GROUP 4	5
209	CLASSROOM	36
213	CLASSROOM	36
216	CLASSROOM	36
240	CLASSROOM	36
248	CLASSROOM	36
252	SMALL GROUP 2	5
302	CLASSROOM	36
308	CLASSROOM	36
232	CAFETERIA	16

# Bristol Forestville

## Bristol, CT

### FF and E Specifications by Item

**Item:** Student Chair

**Item Code:** C-17F

**Manufacturer:** VS

**Total Quantity:** 34

**Model:** Panto Swing-VF Comfort Size Seat

**Category:** C-2

**Description:** Stacking forward-flexing cantilever chair w/one-piece bent round steel tube base, cross bar support and universal glides. Beech plywood seat shell w/anti-slip finish, grip hole and concealed seat attachments.

**Dimensions:** 17"Wx16 1/2"Dx17" Seat Height  
Comfort Size Seat

**Finish:** Frame: M059 Arctic  
Seat & Back: H010 Natural



**Power / Data:**

Room #	Room Name	Qty
100	MEDIA CENTER	28
163F	OFFICE	2

Room #	Room Name	Qty
143B	OFFICE	1

Room #	Room Name	Qty
163	WAITING	3

**Bristol Forestville**  
**Bristol, CT**  
**FF and E Specifications by Item**

**Item:** Chair-Star Base - Adjustable Height

**Item Code:** C-18

**Manufacturer:** VS

**Total Quantity:** 42

**Model:** Panto Move-LuPo Comfort Size Shell

**Category:** C-2

**Description:** Five-star foot chair w/ gas-spring height adjustment and swivel. Textured polypropylene seat shell w/grip hole, double-walled construction with air-cushion effect and castors for hard flooring.

**Dimensions:** 17"Wx16 1/2"Dx16 5/8"-20 1/2"Seat Height  
 Comfort Size Shell

**Finish:** Frame: M059 Arctic  
 Shell: C 029 Dark Blue



**Power / Data:**

Room #	Room Name	Qty
117	COMPUTER ROOM	26

Room #	Room Name	Qty
146	MIDDLE SCHOOL MUSIC	16

Room #	Room Name	Qty
--------	-----------	-----

# Bristol Forestville

## Bristol, CT

### FF and E Specifications by Item

**Item:** Chair-Star Base - Adjustable Height

**Item Code:** C-18F

**Manufacturer:** VS

**Total Quantity:** 8

**Model:** Panto Move-VF Comfort Size Seat

**Category:** C-2

**Description:** Five-star foot chair w/ gas-spring height adjustment, fixed (non-swivel). Seat shell beech plywood w/anti-slip finish, grip hole and castors for carpet flooring.

**Dimensions:** 17 1/2"Wx17 1/8"Dx16 5/8"-20 1/2"Seat Height  
Comfort Size Seat

**Finish:** Frame: M059 Arctic  
Seat & Back: M010 Natural



**Power / Data:**

Room #	Room Name	Qty
100B	OPAC	6

Room #	Room Name	Qty
143	FAMILY RESOURCE ROOM	2

Room #	Room Name	Qty
--------	-----------	-----

**Bristol Forestville**  
**Bristol, CT**  
**FF and E Specifications by Item**

**Item:** Stack Chair **Item Code:** C-19  
**Manufacturer:** Fixtures **Total Quantity:** 320  
**Model:** Fetch Armless Stack Chair **Category:** A-1  
**Description:** Plastic Shell, Armless, Sled Base Stack Chair with chrome frame - ganging w/clear plastic hard floor glides.  
  
**Dimensions:** 20"Wx24.5"Dx33"H  
17.5" Seat Height  
  
**Finish:** Frame: Bright Chrome  
Plastic Shell: Night



**Power / Data:**

Room #	Room Name	Qty
148H	CHAIR STORAGE	320

Room #	Room Name	Qty
--------	-----------	-----

Room #	Room Name	Qty
--------	-----------	-----

# Bristol Forestville

## Bristol, CT

### FF and E Specifications by Item

**Item:** Chair -Stacking Guest & Conference

**Item Code:** C-2

**Manufacturer:** Harter

**Total Quantity:** 38

**Model:** Cyclus

**Category:** A-1

**Description:** Armless, sled base chair with bent plywood outer shell, upholstered seat & back.

**Dimensions:** 19 1/2"Wx16 3/4"Dx31 1/2"OH 19"SH

**Finish:** Frame: #22 Brushed  
 Outer Shell: Natural European Beech  
 Upholstery: **Conference** Qty (20), COM - Pallas Textiles, Jacks/Pacific Blue  
**Admin Offices** Qty (18), COM - Maharam Skate 462370 Force Field Color 005 Opaline.



**Power / Data:**

Room #	Room Name	Qty
101	ASSISTANT COUNCELOR	4
104	PSYCH.	1
109	PRINCIPAL	4
167	OFFICE	3

Room #	Room Name	Qty
102	CONFERENCE ROOM	8
105	GUIDANCE COUNCELOR	1
111	AP	1

Room #	Room Name	Qty
103	PSYCH.	1
108	CONFERENCE ROOM	12
112	AP	3

# Bristol Forestville

## Bristol, CT

### FF and E Specifications by Item

**Item:** Chair-Task Armless

**Item Code:** C-3

**Manufacturer:** Harter

**Total Quantity:** 74

**Model:** Anthro KB

**Category:** A-1

**Description:** Full-back chair w/gas lift, swivel tilt. Soft wheel casters for hard floors and hard wheel casters for carpeted floors.

**Dimensions:** 26 1/2"Wx26"Dx 16"-21"SH

**Finish:** Frame: #22 Brushed  
 Back: Harter Knit Mesh - Color- Silver  
 Seat: COM: Carnegie, Grid #6224, color:11, width 54", repeat 7 1/2" x 14" w,  
 backing: acrylic backed, Finish: greenshield



**Power / Data:**

Room #	Room Name	Qty
116A	ES ISS	1
121	ELEMENTARY ART ROOM	1
125	CLASSROOM	1
130	OT/PT	1
133	SMALL GROUP	1
136	CLASSROOM	1
139	CLASSROOM	1
146	MIDDLE SCHOOL MUSIC	1
148J	PRACTICE	1
154	CLASSROOM	1
160	CLASSROOM	1
163F	OFFICE	1
207	ES SCIENCE	1
212	CLASSROOM	1
215	CLASSROOM	1

Room #	Room Name	Qty
116B	MS ISS	1
123	CLASSROOM	1
126	CLASSROOM	1
131	SMALL GROUP	1
134	CUSTODIAN STORAGE	1
137	CLASSROOM	1
143B	OFFICE	1
148C	OFFICE	1
151	DANCE/DRAMA ROOM	1
157	HEALTH	1
161	CLASSROOM	1
201	MS SPECIAL ED	1
209	CLASSROOM	1
213	CLASSROOM	1
216	CLASSROOM	1

Room #	Room Name	Qty
117	COMPUTER ROOM	1
124	CLASSROOM	1
127	CLASSROOM	1
132	SMALL GROUP	1
135	CLASSROOM	1
138	CLASSROOM	1
144	ELEMENTARY SCHOOL MUSIC	1
148E	OFFICE	1
153	CLASSROOM	1
158	CLASSROOM	1
163C	NURSE ADMIN.	1
205	SMALL GROUP 5	1
211	CLASSROOM	1
214	CLASSROOM	1
217	CLASSROOM	1

**Bristol Forestville**  
**Bristol, CT**  
**FF and E Specifications by Item**

219	ES SPECIAL ED	1
224	CLASSROOM	1
227	CLASSROOM	1
231	CLASSROOM	1
240	CLASSROOM	1
246	CLASSROOM	1
251	SMALL GROUP 1	1
254	WORLD LANGUAGE	1
306	CLASSROOM	1
204	SMALL GROUP 4	1

221	CLASSROOM	1
225	CLASSROOM	1
228	CLASSROOM	1
234A	OFFICE	2
241	CLASSROOM	1
248	CLASSROOM	1
252	SMALL GROUP 2	1
302	CLASSROOM	1
308	CLASSROOM	1

223	CLASSROOM	1
226	CLASSROOM	1
229	CLASSROOM	1
238A	ENGINEERING COMPUTER LAB	1
245	MIDDLE SCHOOL ART ROOM	1
250	CLASSROOM	1
253	SMALL GROUP 3	1
303	CLASSROOM	1
309	CLASSROOM	1

# Bristol Forestville

## Bristol, CT

### FF and E Specifications by Item

**Item:** Teacher Task Chair - Armless

**Item Code:** C-4

**Manufacturer:** Harter - HAG

**Total Quantity:** 44

**Model:** Wing Chair

**Category:** A-1

**Description:** Rocking, armless task chair w/gas lift, swivel tilt and soft wheel casters for hard floors. Upholstered pads at seat and back.

**Dimensions:** 18.25" W x 23.75" D x 33.5-38.25" H, 15-20.5: Seat Height

**Finish:** Frame: Grey  
Upholstery: COM: Architex Name: Otti, Color: Industry, 54"w Repeat: 8.5V, 14.25"h



**Power / Data:**

Room #	Room Name	Qty
123	CLASSROOM	1
126	CLASSROOM	1
136	CLASSROOM	1
139	CLASSROOM	1
161	CLASSROOM	1
205	SMALL GROUP 5	1
212	CLASSROOM	1
215	CLASSROOM	1
219	ES SPECIAL ED	2
224	CLASSROOM	1
227	CLASSROOM	1
231	CLASSROOM	1
248	CLASSROOM	1
302	CLASSROOM	1
309	CLASSROOM	1

Room #	Room Name	Qty
124	CLASSROOM	1
127	CLASSROOM	1
137	CLASSROOM	1
154	CLASSROOM	1
201	MS SPECIAL ED	1
209	CLASSROOM	1
213	CLASSROOM	1
216	CLASSROOM	1
221	CLASSROOM	1
225	CLASSROOM	1
228	CLASSROOM	1
240	CLASSROOM	1
250	CLASSROOM	1
303	CLASSROOM	1

Room #	Room Name	Qty
125	CLASSROOM	1
135	CLASSROOM	1
138	CLASSROOM	1
160	CLASSROOM	1
204	SMALL GROUP 4	1
211	CLASSROOM	1
214	CLASSROOM	1
217	CLASSROOM	1
223	CLASSROOM	1
226	CLASSROOM	1
229	CLASSROOM	1
241	CLASSROOM	1
254	WORLD LANGUAGE	1
308	CLASSROOM	1

# Bristol Forestville

## Bristol, CT

### FF and E Specifications by Item

**Item:** Chair- Four- Leg, Armless w/Casters

**Item Code:** C-5

**Manufacturer:** KI

**Total Quantity:** 34

**Model:** Strive

**Category:** L

**Description:** Mobile, flexible chair with polypropylene shell, slatted back, steel rod frame & steel tube legs for support and casters for hard floors. Flex back.



**Dimensions:** 25" W x 22 1/2" D x 33 1/4" OH, 17 3/4" SH

**Finish:** Frame: Powdercoated Steel - Light Tone  
 Shell: Polypropylene - LT Light Tone  
 Seat Upholstery - COM Carnegie Grid Color: 13,  
 54"w Repeat 7.5"l x 14"w.

**Power / Data:**

Room #	Room Name	Qty
119A	TEACHER PLANNING	6
233	FACULTY DINING	12

Room #	Room Name	Qty
134	CUSTODIAN STORAGE	4
249	TEACHER WORKROOM	6

Room #	Room Name	Qty
162A	TEACHERS PLANNING	6

# Bristol Forestville

## Bristol, CT

### FF and E Specifications by Item

**Item:** Student Art Chair - Elementary

**Item Code:** C-6

**Manufacturer:** Columbia

**Total Quantity:** 36

**Model:** 1527 Stretcher Chair

**Category:** C-2

**Description:** Steel Tube Frame "x" stretcher base student chair w/hard plastic seat & back.

**Dimensions:** Fixed 17.5" Seat height

**Finish:** Frame: Chrome  
Seat & Back: Navy



**Power / Data:**

Room #	Room Name	Qty
121	ELEMENTARY ART ROOM	31

Room #	Room Name	Qty
245	MIDDLE SCHOOL ART ROOM	5

Room #	Room Name	Qty
--------	-----------	-----

**Bristol Forestville**  
**Bristol, CT**  
**FF and E Specifications by Item**

**Item:** Chair & Table Set **Item Code:** C-7  
**Manufacturer:** Early Childhood Resources **Total Quantity:** 5  
**Model:** School Specialty #1329724 **Category:** D  
**Description:** Children's cushioned chair and table set - includes 2 chairs and 1 table.  
**Dimensions:** Chair: 16"Wx19"Dx25.5"OH 13"SH  
**Finish:** Wood: Natural Birch  
 Upholstery: Color TBS from manf full selection.



**Power / Data:**

Room #	Room Name	Qty
123	CLASSROOM	1
126	CLASSROOM	1

Room #	Room Name	Qty
124	CLASSROOM	1
127	CLASSROOM	1

Room #	Room Name	Qty
125	CLASSROOM	1

# Bristol Forestville

## Bristol, CT

### FF and E Specifications by Item

**Item:** Bean Bag Chair **Item Code:** C-9

**Manufacturer:** Gressco **Total Quantity:** 1

**Model:** #4172 Bean Bag Chair **Category:** D

**Description:** Medium Bean Bag Chair - with zip off, washable cover. Baged polystyrene balls inside. CAL117 compliant.

**Dimensions:** 92" Diameter

**Finish:** Color: Dark Denim

**Power / Data:**



Room #	Room Name	Qty
102	CONFERENCE ROOM	1

Room #	Room Name	Qty
--------	-----------	-----

Room #	Room Name	Qty
--------	-----------	-----

**Bristol Forestville**  
**Bristol, CT**  
**FF and E Specifications by Item**

**Item:** Chair Dolly - For Fetch Stack Chairs

**Item Code:** CD-1

**Manufacturer:** Fixtures

**Total Quantity:** 8

**Model:** Chair Dolly for Fetch #00062

**Category:** A-1

**Description:** 4-Wheel Dolly for Fetch Stack Chairs. Stacks 40 chairs each.

**Dimensions:** 20.5"Wx36"Wx19"H

**Finish:** Steel Powdercoat: black

**Power / Data:**



Room #	Room Name	Qty
148H	CHAIR STORAGE	8

Room #	Room Name	Qty
--------	-----------	-----

Room #	Room Name	Qty
--------	-----------	-----

**Bristol Forestville**  
**Bristol, CT**  
**FF and E Specifications by Item**

**Item:** Coat Hooks **Item Code:** CH-1  
**Manufacturer:** Doug Mockett **Total Quantity:** 2  
**Model:** CH26B-87 **Category:** B  
**Description:** Wall Mounted Coat Hooks (4 hooks). Wood base with low profile double satin aluminum hooks. Installed per manf recommended method.  
**Dimensions:** 27.5"Wx1.25"Dx3.25"H  
**Finish:** Wood: Beech  
Hooks: Satin Aluminum



**Power / Data:**

Room #	Room Name	Qty
102	CONFERENCE ROOM	1

Room #	Room Name	Qty
108	CONFERENCE ROOM	1

Room #	Room Name	Qty
--------	-----------	-----

# Bristol Forestville

## Bristol, CT

### FF and E Specifications by Item

**Item:** Credenza **Item Code:** CR-1

**Manufacturer:** KI **Total Quantity:** 1

**Model:** 700 Series - Curve **Category:** L

**Description:** Two, side by side (ganged) Steel Two Drawer Lateral File w/ curve style pulls, plastic laminate top, hardware for front-to-back and side-to-side filing, key alike by room and include counterbalance.

**Dimensions:** 60"Wx18"Dx29.5"Overall Height  
(2 files @ 30"W each)

**Finish:** Steel Powdercoat: Nordic  
Plastic Laminate: Kensington Maple with Matching 74P Edge



**Power / Data:**

Room #	Room Name	Qty
102	CONFERENCE ROOM	1

Room #	Room Name	Qty
--------	-----------	-----

Room #	Room Name	Qty
--------	-----------	-----

**Bristol Forestville**  
**Bristol, CT**  
**FF and E Specifications by Item**

---

**Item:** Credenza

**Item Code:** CR-2

**Manufacturer:** Gunlocke

**Total Quantity:** 1

**Model:** Trio

**Category:** A-1

**Description:** Buffet Credenza with 4 drawers over 4 hinged doors - wood cabinet with plastic laminate top.



**Dimensions:** 74"Wx24"Dx34 3/16"H

**Finish:** Wood: Natural Maple  
 Plastic Laminate: Natural Maple  
 Metal Hardware: Silver

**Power / Data:**

Room #	Room Name	Qty
108	CONFERENCE ROOM	1

Room #	Room Name	Qty
--------	-----------	-----

Room #	Room Name	Qty
--------	-----------	-----

# Bristol Forestville

## Bristol, CT

### FF and E Specifications by Item

**Item:** Desk/Table - Adjustable Height

**Item Code:** D-1

**Manufacturer:** Fixtures

**Total Quantity:** 65

**Model:** Dewey Tables - ADA

**Category:** A-1

**Description:** Adjustable Height Table/Desk - 1 1/8" thick high pressure laminate, particle board core w/steel support channel for level worksurface, edged and backed with moisture-resistant covering to form completely sealed outside surface, urethane edge, pin-height adjustable C-legs with hard floor type leveling glides, worksurface mounted P-Lam modesty panel with 2mm PVC-free edgeband and 3 steel mounting plates that fasten to underside of worksurface.



**Dimensions:** 27"Dx60"Wx27"-34"H ADA clearance

**Finish:** Frame/Legs: E-06 Satin Silver  
P-Lam Top & Modesty: Wilsonart Fusion Maple  
Edge: Urethane - U04 - Dolphin

**Power / Data:** Include (2 )grommets  
Horizontal Wire Management @ inside of modesty  
Vertical Wire Management @ leg adjacent to power source

Room #	Room Name	Qty
116A	ES ISS	1
121	ELEMENTARY ART ROOM	1
125	CLASSROOM	1
130	OT/PT	1
133	SMALL GROUP	1
136	CLASSROOM	1
139	CLASSROOM	1
148C	OFFICE	1
153	CLASSROOM	1
160	CLASSROOM	1
201	MS SPECIAL ED	1

Room #	Room Name	Qty
116B	MS ISS	1
123	CLASSROOM	1
126	CLASSROOM	1
131	SMALL GROUP	1
134	CUSTODIAN STORAGE	1
137	CLASSROOM	1
143B	OFFICE	1
148E	OFFICE	1
154	CLASSROOM	1
161	CLASSROOM	1
205	SMALL GROUP 5	1

Room #	Room Name	Qty
117	COMPUTER ROOM	1
124	CLASSROOM	1
127	CLASSROOM	1
132	SMALL GROUP	1
135	CLASSROOM	1
138	CLASSROOM	1
144	ELEMENTARY SCHOOL MUSIC	1
151	DANCE/DRAMA ROOM	1
157	HEALTH	1
163F	OFFICE	1
209	CLASSROOM	1

**Bristol Forestville**  
**Bristol, CT**  
**FF and E Specifications by Item**

211	CLASSROOM	1
214	CLASSROOM	1
217	CLASSROOM	1
223	CLASSROOM	1
226	CLASSROOM	1
229	CLASSROOM	1
240	CLASSROOM	1
250	CLASSROOM	1
253	SMALL GROUP 3	1
303	CLASSROOM	1
204	SMALL GROUP 4	1

212	CLASSROOM	1
215	CLASSROOM	1
219	ES SPECIAL ED	1
224	CLASSROOM	1
227	CLASSROOM	1
231	CLASSROOM	1
241	CLASSROOM	1
251	SMALL GROUP 1	1
254	WORLD LANGUAGE	1
308	CLASSROOM	1

213	CLASSROOM	1
216	CLASSROOM	1
221	CLASSROOM	1
225	CLASSROOM	1
228	CLASSROOM	1
234A	OFFICE	2
248	CLASSROOM	1
252	SMALL GROUP 2	1
302	CLASSROOM	1
309	CLASSROOM	1

# Bristol Forestville

## Bristol, CT

### FF and E Specifications by Item

**Item:** Student Wing Desk

**Item Code:** D-2

**Manufacturer:** Smith Systems

**Total Quantity:** 922

**Model:** Wing - 03095 ADA

**Category:** C-2

**Description:** Triangular Shaped Desk w/out bookbox (confirm for elementary). with 3 fully welded elliptical leg components. The top plates are 14 gauge steel, each welded to a 14 gauge 1"x1" tube. A 16 gauge elliptical tube is welded to each top plate and each square tube for maximum durability. All three leg weldments are joined at the center by one connector bolt and nut pair. The entire assembly is fastened to the top with 12 fasteners. The pre-drilled top is 1 1/4" thick high density particle board double sided with .30" HPL work surface and mechanically fastened 3/8" Bumper T-mold edge. Legs terminate with sock style glide caps and large fine tune adjustable leveling, hard floor type glides.



**Dimensions:** 30"Wx30"D(41"on one side)x21.5-31.5" Adjustable Height - ADA Clearance

**Finish:** Top: Plastic Laminate - Wilsonart Fusion Maple  
 Edge: Blueberry @ elementary classrooms east wing, Apple @ middle school classrooms west wing  
 Frame & Legs: Platinum

**Power / Data:**

Room #	Room Name	Qty
123	CLASSROOM	1
126	CLASSROOM	1
135	CLASSROOM	24
138	CLASSROOM	23
157	HEALTH	21
201	MS SPECIAL ED	16
212	CLASSROOM	26
215	CLASSROOM	26
219	ES SPECIAL ED	16

Room #	Room Name	Qty
124	CLASSROOM	1
127	CLASSROOM	1
136	CLASSROOM	24
139	CLASSROOM	24
160	CLASSROOM	26
209	CLASSROOM	26
213	CLASSROOM	26
216	CLASSROOM	26
221	CLASSROOM	24

Room #	Room Name	Qty
125	CLASSROOM	1
130	OT/PT	1
137	CLASSROOM	24
154	CLASSROOM	26
161	CLASSROOM	26
211	CLASSROOM	26
214	CLASSROOM	26
217	CLASSROOM	26
223	CLASSROOM	24

**Bristol Forestville**  
**Bristol, CT**  
**FF and E Specifications by Item**

224	CLASSROOM	24
227	CLASSROOM	26
231	CLASSROOM	26
248	CLASSROOM	26
302	CLASSROOM	26
309	CLASSROOM	26

225	CLASSROOM	24
228	CLASSROOM	26
240	CLASSROOM	26
250	CLASSROOM	26
303	CLASSROOM	26

226	CLASSROOM	24
229	CLASSROOM	26
241	CLASSROOM	26
254	WORLD LANGUAGE	26
308	CLASSROOM	26

# Bristol Forestville

## Bristol, CT

### FF and E Specifications by Item

**Item:** Desk/Table - Adjustable Height

**Item Code:** D-3

**Manufacturer:** Fixtures

**Total Quantity:** 2

**Model:** Dewey Tables - ADA

**Category:** A-1

**Description:** Adjustable Height Table/Desk - 1 1/8" thick high pressure laminate, particle board core w/steel support channel for level worksurface, edged and backed with moisture-resistant covering to form completely sealed outside surface, urethane edge, pin-height adjustable C-legs with hard floor type leveling glides, worksurface mounted P-Lam modesty panel with 2mm PVC-free edgeband and 3 steel mounting plates that fasten to underside of worksurface.

**Dimensions:** 27"Dx72"Wx27"-34"H ADA clearance

**Finish:** Frame/Legs: E-06 Satin Silver  
P-Lam Top & Modesty: Wilsonart Fusion Maple  
Edge: Urethane - U04 - Dolphin

**Power / Data:** Include (2 )grommets  
Horizontal Wire Management @ inside of modesty  
Vertical Wire Management @ leg adjacent to power source



Room #	Room Name	Qty
100C	LITERACY	1

Room #	Room Name	Qty
163C	NURSE ADMIN.	1

Room #	Room Name	Qty
--------	-----------	-----

# Bristol Forestville

## Bristol, CT

### FF and E Specifications by Item

**Item:** Student Desk- Adjustable Height

**Item Code:** D-4

**Manufacturer:** Smith System

**Total Quantity:** 30

**Model:** Interchange Desk w/Book Box

**Category:** C-2

**Description:** Open Front Desk w/built-in Book Box - desktop constructed w/1 1/4" thick high density particle board double sided with .30" HPL surfaces and mechanically fastened 3/8" bumper T-mold edge. 1" increment height adjustable ellipse legs constructed of 16ga w/chrome plated steel stems & inserts terminate w/sock style glide caps over fine tune adjustable leveling, hard floor type glides. Legs securely attach to 18ga formed welded steel bookbox w/integrated pencil retainer with 2 bolts per leg.



**Dimensions:** 20"Dx27"Wx 21 1/2"-31 1/2"H

**Finish:** Top: Plastic Laminate - Wilsonart Fusion Maple  
Edge: Blueberry  
Frame & Legs: Platinum

**Power / Data:**

Room #	Room Name	Qty
116A	ES ISS	2

Room #	Room Name	Qty
116B	MS ISS	2

Room #	Room Name	Qty
207	ES SCIENCE	26

**Bristol Forestville**  
**Bristol, CT**  
**FF and E Specifications by Item**

**Item:** Student Desk- Adjustable Height

**Item Code:** D-5

**Manufacturer:** Smith System

**Total Quantity:** 3

**Model:** Interchange-Activity Table - ADA

**Category:** C-2

**Description:** Rectangular Activity Table - 1 1/4" thick high density particle board double sided with .30" HPL surfaces and mechanically fastened 3/8" bumper T-mold edge. Tops are pre-drilled for leg set attachment and are supported by one or more 2"x3" channels with 4 breakovers for optimum strength. 1" increment height adjustable ellipse legs constructed of 16ga stems & inserts, 14ga cross braces & 12ga plates w/each leg height secured by two 3/8" set screws. Legs terminate with sock style glide caps and large fine tune adjustable leveling, hard floor type glides.



**Dimensions:** 24"Dx54"Wx 22"-34"H ADA Clearance

**Finish:** Top: Plastic Laminate - Wilsonart Fusion Maple  
 Edge: Blueberry  
 Frame & Legs: Platinum

**Power / Data:**

Room #	Room Name	Qty
116A	ES ISS	1

Room #	Room Name	Qty
116B	MS ISS	1

Room #	Room Name	Qty
207	ES SCIENCE	1

# Bristol Forestville

## Bristol, CT

### FF and E Specifications by Item

**Item:** Private Office Workstation **Item Code:** D-6  
**Manufacturer:** Gunlocke **Total Quantity:** 6  
**Model:** Trio - ADA **Category:** A-1  
**Description:** Credenza Desk w/Upper Cabinets, Pedestal File & 4 Door Wardrobe Tower  
 Trio Credenza Desk with plastic laminate worksurface with square wood edges, grommets and wire management, access to outlets in wall, painted upper cabinets, tackboard, task light (ACLE60), BBF pedestal file w/pencil tray and wardrobe/FF /storage cabinet tower. Include file hanging hardware, designated locking cores and counterbalance weights for files and storage. Refer to plan to confirm handed designations.



**Dimensions:** Overall - 114"Wx24"Dx68.25"H  
 Credenza Shell with B/B/F Pedestal & Hutch - 90"Wx24"D ADA Accessible  
 Storage Tower 24"Wx24"D

**Finish:** Wood: Natural Maple  
 Plastic Laminate: Natural Maple  
 Paint - Upper Cabinets: Soft White  
 Metal Hardware: Silver

**Power / Data:** Grommets, Wire Manager Under Worksurface, Task Light

Room #	Room Name	Qty
103	PSYCH.	1
111	AP	1

Room #	Room Name	Qty
104	PSYCH.	1
112	AP	1

Room #	Room Name	Qty
105	GUIDANCE COUNCELOR	1
167	OFFICE	1

**Bristol Forestville**  
**Bristol, CT**  
**FF and E Specifications by Item**

**Item:** Reception Desk

**Item Code:** D-7

**Manufacturer:** KI

**Total Quantity:** 1

**Model:** Darwin / Aristotle Reception Desk - ADA

**Category:** L

**Description:** **L-shape Reception Desk**  
 Reception desk w/transaction counter and right hand return without transaction counter, right hand locking box/box/file pedestal with file hanging hardware & pencil tray.



**Dimensions:** Reception Desk & Transaction Counter: 66"x30"x42"H ADA Accessible  
 Return: 48"x24" ADA Transaction

**Finish:** Wood Veneer: Natural on Maple  
 Plastic Laminate: Maple  
 Metal Hardware: Silver

**Power / Data:** Grommets at worksurfaces & through end panel to wall behind pedestal file.  
 Wire management trough below work surfaces.

Room #	Room Name	Qty
101	ASSISTANT COUNCELOR	1

Room #	Room Name	Qty
--------	-----------	-----

Room #	Room Name	Qty
--------	-----------	-----

# Bristol Forestville

## Bristol, CT

### FF and E Specifications by Item

**Item:** Desk/Table - Adjustable Height

**Item Code:** D-8

**Manufacturer:** Fixtures

**Total Quantity:** 2

**Model:** Dewey Tables - ADA

**Category:** A-1

**Description:** Adjustable Height Table/Desk - 1 1/8" thick high pressure laminate, particle board core w/steel support channel for level worksurface, edged and backed with moisture-resistant covering to form completely sealed outside surface, urethane edge, pin-height adjustable C-legs with hard floor type leveling glides, worksurface mounted P-Lam modesty panel with 2mm PVC-free edgeband and 3 steel mounting plates that fasten to underside of worksurface.

**Dimensions:** 24"Dx72"Wx27"-34"H ADA clearance  
Set to match height of adjacent millwork.

**Finish:** Frame/Legs: E-06 Satin Silver  
P-Lam Top & Modesty: Wilsonart Fusion Maple  
Edge: Urethane - U04 - Dolphin

**Power / Data:** Include (2 )grommets  
Horizontal Wire Management @ inside of modesty  
Vertical Wire Management @ leg adjacent to power source



Room #	Room Name	Qty
107	ADMINISTRATION	2

Room #	Room Name	Qty

Room #	Room Name	Qty

# Bristol Forestville

## Bristol, CT

### FF and E Specifications by Item

**Item:** Principal Workstation **Item Code:** D-9

**Manufacturer:** Gunlocke **Total Quantity:** 1

**Model:** Trio - ADA **Category:** A-1

**Description:** U-shape Workstation w/Upper Cabinets, Pedestal File & 4 Door Wardrobe Tower  
 Extended racetrack w/column & half modesty, bridge & credenza desk w/plastic laminate worksurface with square wood edges, grommets and wire management, access to outlets in wall, painted upper cabinets, tackboard, task light, BBF pedestal file w/pencil tray and wardrobe/FF /storage cabinet tower. Include file hanging hardware, designated locking cores and counterbalance weights for files and storage. Refer to plan to confirm handed designations.

**Dimensions:** Overall: 96"Wx102"Dx68.25"H ADA Accessible  
 Extended Racetrack - 42"x72"  
 Bridge - 24"x36",  
 Credenza Shell w/BBF Pedestal & Hutch - 24"x72x68.25"H  
 Storage Tower 24"x 24"x68.25"

**Finish:** Wood: Natural Maple  
 Plastic Laminate: Natural Maple  
 Paint - Upper Cabinets: Soft White  
 Metal Hardware: Silver

**Power / Data:** Grommets, Wire Manager Under Worksurface, Task Light



Room #	Room Name	Qty
109	PRINCIPAL	1

Room #	Room Name	Qty
--------	-----------	-----

Room #	Room Name	Qty
--------	-----------	-----

# Bristol Forestville

## Bristol, CT

### FF and E Specifications by Item

**Item:** Desk Return/Table - Adjustable Heigh

**Item Code:** DR-1

**Manufacturer:** Fixtures

**Total Quantity:** 17

**Model:** Dewey Tables - ADA

**Category:** A-1

**Description:** Adjustable Height Table/Desk Return- 1 1/8" thick high pressure laminate, particle board core - edged and backed with moisture-resistant covering to form completely sealed outside surface, urethane edge, pin-height adjustable C-legs with hard floor type leveling glides. Include (1) centered grommet, horizontal and vertical wire management.

**Dimensions:** 24"Dx48"Wx 27"-34"H ADA clearance

**Finish:** Frame/Legs: E-06 Satin Silver  
P-Lam Top & Modesty: Wilsonart Fusion Maple  
Edge: Urethane - U04 - Dolphin



**Power / Data:**

Room #	Room Name	Qty
117	COMPUTER ROOM	1
133	SMALL GROUP	1
148E	OFFICE	1
163F	OFFICE	1
251	SMALL GROUP 1	1
254	WORLD LANGUAGE	1

Room #	Room Name	Qty
131	SMALL GROUP	1
144	ELEMENTARY SCHOOL MUSIC	1
151	DANCE/DRAMA ROOM	1
201	MS SPECIAL ED	1
252	SMALL GROUP 2	1
204	SMALL GROUP 4	1

Room #	Room Name	Qty
132	SMALL GROUP	1
148C	OFFICE	1
157	HEALTH	1
205	SMALL GROUP 5	1
253	SMALL GROUP 3	1

# Bristol Forestville

## Bristol, CT

### FF and E Specifications by Item

**Item:** Easel-Teaching

**Item Code:** E-1

**Manufacturer:** Best-Rite - Demco

**Total Quantity:** 44

**Model:** Wheasel with Tubs

**Category:** D

**Description:** Mobile Folding Easel w/Tubs - Features: Markerboard @ front & back, middle storage tray for supplies, wire book rack & big book holder, steel construction, 2" diameter locking casters for hard floor, folds flat for storage, full length marker tray on each side & 6"Deep removable storage tubs.

**Dimensions:** 30.5"Wx34"Dx55"H

**Finish:** Powdercoat: White

**Power / Data:**



Room #	Room Name	Qty
117	COMPUTER ROOM	1
125	CLASSROOM	1
135	CLASSROOM	1
138	CLASSROOM	1
154	CLASSROOM	1
161	CLASSROOM	1
211	CLASSROOM	1
214	CLASSROOM	1
217	CLASSROOM	1
223	CLASSROOM	1
226	CLASSROOM	1
229	CLASSROOM	1
241	CLASSROOM	1
254	WORLD LANGUAGE	1
308	CLASSROOM	1

Room #	Room Name	Qty
123	CLASSROOM	1
126	CLASSROOM	1
136	CLASSROOM	1
139	CLASSROOM	1
157	HEALTH	1
201	MS SPECIAL ED	1
212	CLASSROOM	1
215	CLASSROOM	1
219	ES SPECIAL ED	1
224	CLASSROOM	1
227	CLASSROOM	1
231	CLASSROOM	1
248	CLASSROOM	1
302	CLASSROOM	1
309	CLASSROOM	1

Room #	Room Name	Qty
124	CLASSROOM	1
127	CLASSROOM	1
137	CLASSROOM	1
143	FAMILY RESOURCE ROOM	1
160	CLASSROOM	1
209	CLASSROOM	1
213	CLASSROOM	1
216	CLASSROOM	1
221	CLASSROOM	1
225	CLASSROOM	1
228	CLASSROOM	1
240	CLASSROOM	1
250	CLASSROOM	1
303	CLASSROOM	1

# Bristol Forestville

## Bristol, CT

### FF and E Specifications by Item

**Item:** Easel-Art

**Item Code:** E-2

**Manufacturer:** Jonticraft

**Total Quantity:** 5

**Model:** 0289JC

**Category:** C-1

**Description:** Mobile two station art easel w/storage below and between the removable tabletop hardboard easels. Storage base w/rounded edges, shelf, kickplate, and casters w/caster brackets. Clips and paint tray included.

**Dimensions:** 25.5"Wx20"Dx45"H

**Finish:** Finish: KIDZTuff Birch

**Power / Data:**



Room #	Room Name	Qty
123	CLASSROOM	1
126	CLASSROOM	1

Room #	Room Name	Qty
124	CLASSROOM	1
127	CLASSROOM	1

Room #	Room Name	Qty
125	CLASSROOM	1

**Bristol Forestville**  
**Bristol, CT**  
**FF and E Specifications by Item**

**Item:** Teaching Easel

**Item Code:** E-3

**Manufacturer:** Royal Inspirations

**Total Quantity:** 2

**Model:** Blick 51685-1006

**Category:** D

**Description:** Royale Inspiration Station - Premium Royal 6 Tub Model with slide-out expandable magnetic dry erase board on the front, removable lined magnetic dry erase board on the back, 6 Stubby Tubby's storage tubs, including four open tubs and two divided tubs, working shelf, snap-on paper/accessory hooks, telescoping hooks for pocket charts, height-adjustable book/resource ledge, 4 locking casters with foot-activated braking system.



**Dimensions:** 61½"H x 30"W x 30"D

**Finish:** Color: Royal Blue (std)

**Power / Data:**

Room #	Room Name	Qty
121	ELEMENTARY ART ROOM	1

Room #	Room Name	Qty
245	MIDDLE SCHOOL ART ROOM	1

Room #	Room Name	Qty
--------	-----------	-----

# Bristol Forestville

## Bristol, CT

### FF and E Specifications by Item

**Item:** File-Pedestal - Mobile P/B/F

**Item Code:** F-1

**Manufacturer:** KI

**Total Quantity:** 79

**Model:** 700 Series - Curve

**Category:** L

**Description:** Mobile Pedestal Pencil/Box/File w/Curve pulls, hardware for front-to-back filing & locking casters. Include (1) pencil tray, counterbalance & key alike by room.

**Dimensions:** 15"Wx21 5/8"Dx24 11/16"H

**Finish:** Steel Powdercoat: Sunburst SU  
Lock: Silver



**Power / Data:**

Room #	Room Name	Qty
100A	CIRCULATION	2
116A	ES ISS	1
121	ELEMENTARY ART ROOM	1
125	CLASSROOM	1
130	OT/PT	1
133	SMALL GROUP	1
136	CLASSROOM	1
139	CLASSROOM	1
146	MIDDLE SCHOOL MUSIC	1
151	DANCE/DRAMA ROOM	1
157	HEALTH	1
161	CLASSROOM	1
201	MS SPECIAL ED	1
209	CLASSROOM	1
213	CLASSROOM	1
216	CLASSROOM	1

Room #	Room Name	Qty
100C	LITERACY	1
116B	MS ISS	1
123	CLASSROOM	1
126	CLASSROOM	1
131	SMALL GROUP	1
134	CUSTODIAN STORAGE	1
137	CLASSROOM	1
143B	OFFICE	1
148C	OFFICE	1
153	CLASSROOM	1
158	CLASSROOM	1
163C	NURSE ADMIN.	1
205	SMALL GROUP 5	1
211	CLASSROOM	1
214	CLASSROOM	1
217	CLASSROOM	1

Room #	Room Name	Qty
107	ADMINISTRATION	3
117	COMPUTER ROOM	1
124	CLASSROOM	1
127	CLASSROOM	1
132	SMALL GROUP	1
135	CLASSROOM	1
138	CLASSROOM	1
144	ELEMENTARY SCHOOL MUSIC	1
148E	OFFICE	1
154	CLASSROOM	1
160	CLASSROOM	1
163F	OFFICE	1
207	ES SCIENCE	1
212	CLASSROOM	1
215	CLASSROOM	1
219	ES SPECIAL ED	1

**Bristol Forestville**  
**Bristol, CT**  
**FF and E Specifications by Item**

221	CLASSROOM	1
225	CLASSROOM	1
228	CLASSROOM	1
234A	OFFICE	2
241	CLASSROOM	1
248	CLASSROOM	1
252	SMALL GROUP 2	1
302	CLASSROOM	1
308	CLASSROOM	1

223	CLASSROOM	1
226	CLASSROOM	1
229	CLASSROOM	1
238A	ENGINEERING COMPUTER LAB	1
245	MIDDLE SCHOOL ART ROOM	1
250	CLASSROOM	1
253	SMALL GROUP 3	1
303	CLASSROOM	1
309	CLASSROOM	1

224	CLASSROOM	1
227	CLASSROOM	1
231	CLASSROOM	1
240	CLASSROOM	1
246	CLASSROOM	1
251	SMALL GROUP 1	1
254	WORLD LANGUAGE	1
306	CLASSROOM	1
204	SMALL GROUP 4	1

# Bristol Forestville

## Bristol, CT

### FF and E Specifications by Item

---

**Item:** File-Lateral 2-Drawer

**Item Code:** F-10

**Manufacturer:** KI

**Total Quantity:** 11

**Model:** 700 Series - Curve

**Category:** L

**Description:** Steel Lateral File w/ curve style pulls, hardware for front-to-back and side-to-side filing, key alike by room and include counterbalance. Fit under counter.

**Dimensions:** 42"Wx18"Dx27"H (confirm height to clear counter)

**Finish:** Steel Powdercoat: Light Tone  
Lock: Silver



**Power / Data:**

Room #	Room Name	Qty
100A	CIRCULATION	2
145A	MUSIC STORAGE	5

Room #	Room Name	Qty
100C	LITERACY	2

Room #	Room Name	Qty
107	ADMINISTRATION	2

**Bristol Forestville**  
**Bristol, CT**  
**FF and E Specifications by Item**

**Item:** File-Lateral 4-Drawer

**Item Code:** F-11

**Manufacturer:** KI

**Total Quantity:** 4

**Model:** 700 Series - Curve

**Category:** L

**Description:** Steel Lateral File w/ Curve Pulls, hardware for front-to-back and side-to-side filing, key alike by room, and include counterbalance.

**Dimensions:** 36"Wx18"Dx51 1/2"H

**Finish:** Steel Powdercoat: Light Tone  
 Locks: Silver



**Power / Data:**

Room #	Room Name	Qty
114	FILE ROOM	3

Room #	Room Name	Qty
134	CUSTODIAN STORAGE	1

Room #	Room Name	Qty
--------	-----------	-----

# Bristol Forestville

## Bristol, CT

### FF and E Specifications by Item

**Item:** File-Lateral 4-Drawer

**Item Code:** F-12

**Manufacturer:** KI

**Total Quantity:** 3

**Model:** 700 Series - Curve

**Category:** L

**Description:** Steel Lateral File w/ Curve Pulls, hardware for front-to-back and side-to-side filing, key alike by room, and include counterbalance.

**Dimensions:** 42"Wx18"Dx51 1/2"H

**Finish:** Steel Powdercoat: Light Tone  
Locks: Silver



**Power / Data:**

Room #	Room Name	Qty
114	FILE ROOM	3

Room #	Room Name	Qty
--------	-----------	-----

Room #	Room Name	Qty
--------	-----------	-----

**Bristol Forestville**  
**Bristol, CT**  
**FF and E Specifications by Item**

**Item:** File - Pedestal - Mobile F/F

**Item Code:** F-13

**Manufacturer:** KI

**Total Quantity:** 4

**Model:** 700 Series - Curve

**Category:** L

**Description:** Mobile Pedestal File/File w/Curve pulls, hardware for front-to-back filing, & locking casters. Include counterbalance & key alike by room.

**Dimensions:** 15"Wx21 5/8"Dx27 5/8"H (confirm fit under millwork)

**Finish:** Steel Powdercoat: Light Tone  
 Lock: Silver



**Power / Data:**

Room #	Room Name	Qty
100A	CIRCULATION	2

Room #	Room Name	Qty
107	ADMINISTRATION	2

Room #	Room Name	Qty
--------	-----------	-----

# Bristol Forestville

## Bristol, CT

### FF and E Specifications by Item

**Item:** File - Lateral, Mobile w/ Landing Pad

**Item Code:** F-2

**Manufacturer:** KI

**Total Quantity:** 48

**Model:** All Terrain File Storage Tower - 44" 3  
Drawer Lateral File Unit w/Landing  
Pad

**Category:** L

**Description:** Steel 3 (10 1/2" H) Drawer mobile lateral file w/ 2 accessory slots, metric pulls and plastic laminate landing pad mounted to top. Lock files alike by room, include countrbalance

**Dimensions:** 30"Wx24"Dx44"H

**Finish:** Steel Powdercoat: Sunburst SU  
Pull: Metric - Silver  
Landing Pad: Plam - Kensington Maple  
Edge: Matching 74P Edge



**Power / Data:**

Room #	Room Name	Qty
117	COMPUTER ROOM	1
124	CLASSROOM	1
127	CLASSROOM	1
136	CLASSROOM	1
139	CLASSROOM	1
153	CLASSROOM	1
160	CLASSROOM	1
209	CLASSROOM	1
213	CLASSROOM	1
216	CLASSROOM	1
221	CLASSROOM	1
225	CLASSROOM	1
228	CLASSROOM	1

Room #	Room Name	Qty
121	ELEMENTARY ART ROOM	1
125	CLASSROOM	1
130	OT/PT	1
137	CLASSROOM	1
148C	OFFICE	1
154	CLASSROOM	1
161	CLASSROOM	1
211	CLASSROOM	1
214	CLASSROOM	1
217	CLASSROOM	1
223	CLASSROOM	1
226	CLASSROOM	1
229	CLASSROOM	1

Room #	Room Name	Qty
123	CLASSROOM	1
126	CLASSROOM	1
135	CLASSROOM	1
138	CLASSROOM	1
148E	OFFICE	1
157	HEALTH	1
201	MS SPECIAL ED	1
212	CLASSROOM	1
215	CLASSROOM	1
219	ES SPECIAL ED	1
224	CLASSROOM	1
227	CLASSROOM	1
231	CLASSROOM	1

**Bristol Forestville**  
**Bristol, CT**  
**FF and E Specifications by Item**

---

240	CLASSROOM	1
250	CLASSROOM	1
303	CLASSROOM	1

241	CLASSROOM	1
254	WORLD LANGUAGE	1
308	CLASSROOM	1

248	CLASSROOM	1
302	CLASSROOM	1
309	CLASSROOM	1

# Bristol Forestville

## Bristol, CT

### FF and E Specifications by Item

**Item:** File - Lateral/Storage/Wardrobe

**Item Code:** F-3

**Manufacturer:** KI

**Total Quantity:** 8

**Model:** 700 Series - Curve

**Category:** L

**Description:** 3 Lateral File Drawers w/storage cabinet (markerboard finish doors) above and full height wardrobe cabinet on side -locking doors & drawers with Curve Pulls. Provide hardware for front-to-back and side-to-side filing, key alike by room, and include counterbalance.

**Dimensions:** 30"Wx18"Dx65.5"H

**Finish:** Steel Powdercoat: Light Tone  
Locks: Silver

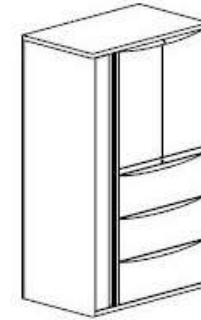

**Power / Data:**

Room #	Room Name	Qty
131	SMALL GROUP	1
204	SMALL GROUP 4	1
253	SMALL GROUP 3	1

Room #	Room Name	Qty
132	SMALL GROUP	1
251	SMALL GROUP 1	1
205	SMALL GROUP 5	1

Room #	Room Name	Qty
133	SMALL GROUP	1
252	SMALL GROUP 2	1

# Bristol Forestville

## Bristol, CT

### FF and E Specifications by Item

**Item:** File - Lateral 2-Drawer

**Item Code:** F-4

**Manufacturer:** KI

**Total Quantity:** 6

**Model:** 700 Series - Curve

**Category:** L

**Description:** Steel Lateral File w/ curve pulls, plastic laminate top, hardware for front-to-back and side-to-side filing, locking - key alike by room, and include counterbalance.

**Dimensions:** 30"Wx18"Dx 27"H plus 1 1/4"H Top

**Finish:** Steel Powdercoat: Nordic  
 Plastic Laminate: Kensington Maple  
 Edge: Matching 74P Edge  
 Locks: Silver



**Power / Data:**

Room #	Room Name	Qty
163F	OFFICE	1
105	GUIDANCE COUNCELOR	1

Room #	Room Name	Qty
103	PSYCH.	1
111	AP	1

Room #	Room Name	Qty
104	PSYCH.	1
112	AP	1

**Bristol Forestville**  
**Bristol, CT**  
**FF and E Specifications by Item**

**Item:** File - Lateral 4 Drawer w/Cupboard

**Item Code:** F-5

**Manufacturer:** KI

**Total Quantity:** 2

**Model:** 700 Series - Curve

**Category:** L

**Description:** Steel Lateral File with hardware for front-to-back and side-to-side filing and Cuboard with shelf above, curve pulls, locking-key alike by room, and include counterbalance.

**Dimensions:** 36"Wx18"Dx77 13/32"H

**Finish:** Steel Powdercoat: Light Tone  
 Lock: Silver



**Power / Data:**

Room #	Room Name	Qty
163C	NURSE ADMIN.	2

Room #	Room Name	Qty
--------	-----------	-----

Room #	Room Name	Qty
--------	-----------	-----

# Bristol Forestville

## Bristol, CT

### FF and E Specifications by Item

---

**Item:** File - Lateral 2-Drawer

**Item Code:** F-8

**Manufacturer:** Gunlocke

**Total Quantity:** 2

**Model:** Trio

**Category:** A-1

**Description:** Two Drawer Lateral File with top. Key alike by room, include counterbalance weight.

**Dimensions:** 30"Wx24"Dx29.25"H

**Finish:** Plastic Laminate: Natural Maple  
Metal Hardware: Silver



**Power / Data:**

Room #	Room Name	Qty
109	PRINCIPAL	2

Room #	Room Name	Qty
--------	-----------	-----

Room #	Room Name	Qty
--------	-----------	-----

# Bristol Forestville

## Bristol, CT

### FF and E Specifications by Item

**Item:** File - Lateral 2-Drawer w/Open Hutch

**Item Code:** F-9

**Manufacturer:** Gunlocke

**Total Quantity:** 3

**Model:** Trio

**Category:** A-1

**Description:** Two Drawer Lateral File with 3 open shelves above. Key alike by room, include counterbalance weight.

**Dimensions:** 30"Wx24"Dx68.25"H

**Finish:** Plastic Laminate: Natural Maple  
Metal Hardware: Silver



**Power / Data:**

Room #	Room Name	Qty
101	ASSISTANT COUNCELOR	2

Room #	Room Name	Qty
167	OFFICE	1

Room #	Room Name	Qty
--------	-----------	-----

# Bristol Forestville

## Bristol, CT

### FF and E Specifications by Item

**Item:** Extended Keyboard Tray **Item Code:** K-1

**Manufacturer:** Humanscale **Total Quantity:** 12

**Model:** 5G-500-G27 Articulating KB Tray **Category:** C-2

**Description:** Dial-a-tilt and height adjustability with "Big" platform, install 27" gel wrist rest fixed to the platform.

**Dimensions:** Mechanism: 6.25" height adjustment 1.25" above track to 5" below track, comes standard with 21.625" track.  
Keyboard: 27"w x 10.625"d built-in mousing surface

**Finish:** Finish: Black



**Power / Data:**

Room #	Room Name	Qty
101	ASSISTANT COUNCELOR	1

Room #	Room Name	Qty
107	ADMINISTRATION	3

Room #	Room Name	Qty
146	MIDDLE SCHOOL MUSIC	8

**Bristol Forestville**  
**Bristol, CT**  
**FF and E Specifications by Item**

**Item:** Island w/Millwork Top

**Item Code:** L-1

**Manufacturer:** Worden

**Total Quantity:** 2

**Model:** Custom - Counter Top

**Category:** G

**Description:** 1 1/2" thick HPL work counter with 1 1/2"Hx 1 1/4"T solid maple edges (profile square eased edge) on 4 sides and brown backer under. 6" radius at all 4 corners. Mount to top of lateral files (specified separately) with consealed hardware for secure installation.

**Dimensions:** 60"Wx42"Dx No Greater than34"H ADA Accessible

**Finish:** Plastic Laminate: Wilsonart "Kensington Maple" 10776-60  
 Clear Hardwood Maple Edge: Finish to Match Architect's Sample  
 Edge Profile: eased wood edge.



**Power / Data:**

Room #	Room Name	Qty
100A	CIRCULATION	1

Room #	Room Name	Qty
100C	LITERACY	1

Room #	Room Name	Qty
--------	-----------	-----

# Bristol Forestville

## Bristol, CT

### FF and E Specifications by Item

**Item:** Book Truck

**Item Code:** L-2

**Manufacturer:** Worden

**Total Quantity:** 1

**Model:** T-3016

**Category:** G

**Description:** Display Wood book truck on 4 swivel and 2 stationary casters. Double faced with two canted book display shelves and one flat base shelf. Each shelf has book stop set at 90 degree angle to shelf.



**Dimensions:** 36"Wx18"Dx38.5"H, 3/4" solid oak construction. Mortise/Tenon end panels

**Finish:** Wood Finish: Maple

**Power / Data:**

Room #	Room Name	Qty
100A	CIRCULATION	0

Room #	Room Name	Qty
100C	LITERACY	0

Room #	Room Name	Qty
167	OFFICE	1

# Bristol Forestville

## Bristol, CT

### FF and E Specifications by Item

**Item:** Depressible Cushioned Book Truck

**Item Code:** L-3

**Manufacturer:** Worden

**Total Quantity:** 1

**Model:** T-320-DBT0J-M with Cushion  
(Special)

**Category:** G

**Description:** Book Truck with depressible padded bottom. Provide padding in bottom to protect books. The ends, bottom, front and back panels are constructed of 3-ply panels, 3/4" thick. The platform will descend as books are added and raise as books are taken out. The book truck has four (4) swivel twin wheel casters, 4" diameter. Steel reinforced rubber bumpers on all four vertical corners.

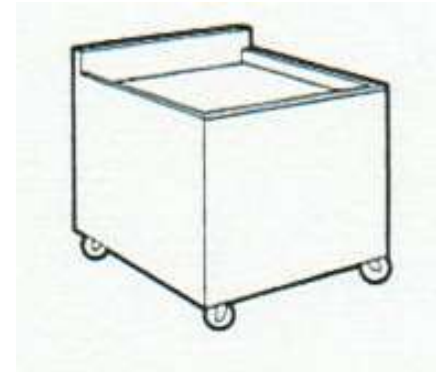

**Dimensions:** 26"Wx22"Dx26.75"H at front and 28.75" at front.

**Finish:** Wood Finish: Maple

**Power / Data:**

Room #	Room Name	Qty
100A	CIRCULATION	1

Room #	Room Name	Qty
--------	-----------	-----

Room #	Room Name	Qty
--------	-----------	-----

# Bristol Forestville

## Bristol, CT

### FF and E Specifications by Item

**Item:** Book Display Spinners

**Item Code:** L-4

**Manufacturer:** Wood Designs

**Total Quantity:** 4

**Model:** Demco #P15314950

**Category:** D

**Description:** Mobile book display - 2 sides provide face-out display of books, while the other 2 sides provide deep shelves for spine-out book storage. Made of durable, 5/8"-thick, 11-ply Baltic birch. Rounded corners and edges for safety. Moves easily on 2" dia. dual-wheel casters.

**Dimensions:** 44"H x 24"W x 24"D

**Finish:** Finish: Natural Baltic Birch  
GreenGuard certified Tuff-Gloss UV finish



**Power / Data:**

Room #	Room Name	Qty
100	MEDIA CENTER	4

Room #	Room Name	Qty
--------	-----------	-----

Room #	Room Name	Qty
--------	-----------	-----

# Bristol Forestville

## Bristol, CT

### FF and E Specifications by Item

**Item:** Book Display - Mobile

**Item Code:** L-5

**Manufacturer:** Jonticraft

**Total Quantity:** 1

**Model:** 3507JC

**Category:** C-1

**Description:** 2 sided Mobile Pick-a-Book Stand - on locking casters. Back is identical to front with equal storage capacity. Eight 1" shelves.

**Dimensions:** 30"Wx16.5"Dx30"H

**Finish:** Finish: KidzTuff Birch  
Dividers: Magnetic Write & Wipe

**Power / Data:**



Room #	Room Name	Qty
100	MEDIA CENTER	1

Room #	Room Name	Qty
--------	-----------	-----

Room #	Room Name	Qty
--------	-----------	-----

# Bristol Forestville

## Bristol, CT

### FF and E Specifications by Item

**Item:** PAC Table **Item Code:** L-6

**Manufacturer:** Worden **Total Quantity:** 1

**Model:** Custom PAC Table - ADA **Category:** G

**Description:** 1 1/2" Thick HPL work top with 1 1/4" Wide solid maple edges (profile TBD) on 4 sides and brown backer under, supported by hardwood maple end panels and recessed supports. Includes (6) 3" grommets, wire management troughs mounted under and low divider down center (length).

**Dimensions:** Overall: 144"Lx48"Dx28"H ADA Accessible  
 Divider: 1 1/2" Tx141 1/2"Wx 4"H

**Finish:** Plastic Laminate: "Kensington Maple" 10776-60  
 Hardwood Maple Edges: Profile Hdwd eased edges  
 Grommets and Hardware: Brushed Aluminum or Satin Stainless Steel

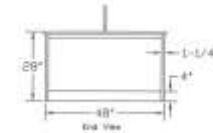
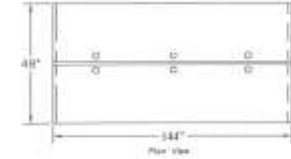

**Power / Data:** TBS

Room #	Room Name	Qty
100B	OPAC	1

Room #	Room Name	Qty
--------	-----------	-----

Room #	Room Name	Qty
--------	-----------	-----

# Bristol Forestville

## Bristol, CT

### FF and E Specifications by Item

---

**Item:** Rolling Cart with Top

**Item Code:** L-8

**Manufacturer:** Smith System

**Total Quantity:** 2

**Model:** Anything Truck with Top

**Category:** C-2

**Description:** Steel, Double Face Mobile Cart w/ one shelf with six bins and two lower flat shelves with dual wheel, soft tread casters for quiet operation. 18ga steel tube frame and 20ga end panels, shelves & bins. - HP plastic laminate top attached to handles with platinum pole supports.

**Dimensions:** 18"Dx36"Wx43"H

**Finish:** Steel Powdercoat: Platinum  
Plastic Laminate: Fusion Maple  
Edge: Platinum



**Power / Data:**

Room #	Room Name	Qty
166	WORKROOM/ STORAGE	2

Room #	Room Name	Qty
--------	-----------	-----

Room #	Room Name	Qty
--------	-----------	-----

**Bristol Forestville**  
**Bristol, CT**  
**FF and E Specifications by Item**

**Item:** Book Stool **Item Code:** L-9  
**Manufacturer:** Cramer - Gaylord **Total Quantity:** 3  
**Model:** Kick Step - WW-1003-20 **Category:** D  
**Description:** Depressible Book Stool with Casters. Metal Stool with foot grips on horizontal surfaces.  
**Dimensions:** 15.5"Dx14"H  
**Finish:** Colors: Silver & Black  
**Power / Data:**



1003-20 Silver

Room #	Room Name	Qty
100	MEDIA CENTER	2

Room #	Room Name	Qty
100C	LITERACY	1

Room #	Room Name	Qty
--------	-----------	-----

# Bristol Forestville

## Bristol, CT

### FF and E Specifications by Item

**Item:** Music-Student Chair

**Item Code:** M-1

**Manufacturer:** Wenger

**Total Quantity:** 99

**Model:** 0930000

**Category:** I

**Description:** 16-gauge, square-tube framing with 14-gauge rear cross member and wear-resistant polypropylene seat and back.  
Greenguard - IAQ Certified



**Dimensions:** 17.5" Seat Height

**Finish:** Frame: Chrome  
Seat & Back: Black

**Power / Data:**

Room #	Room Name	Qty
144	ELEMENTARY SCHOOL MUSIC	13
148J	PRACTICE	6

Room #	Room Name	Qty
146	MIDDLE SCHOOL MUSIC	25

Room #	Room Name	Qty
148F	PLATFORM	55

# Bristol Forestville

## Bristol, CT

### FF and E Specifications by Item

**Item:** Music-Acoustic Shell

**Item Code:** M-10

**Manufacturer:** Wenger

**Total Quantity:** 1

**Model:** 5 Unit Legacy Choral Set

**Category:** I

**Description:** (5 piece set #E535)  
 5 Piece Acoustical Shell w/Tapered Canopy  
 Flat panels in standard 1" construction, 6'-0" wide. Life mechanism to raises and lowers shell. Canopy folds flat for storage, adjustable to 45, 60, 75, 90 degree angles. Kicker panel provides coverage within 2" of floor. Fully extended height of 15'-2" with 54"H tapered canopy & counterweighted base system.



**Dimensions:** Overall: 30' Wide x Adjustable Height 9'-8"-15'-2"H

**Finish:** Composite Panels on Aluminum & Steel Framework. Standard finish

**Power / Data:**

Room #	Room Name	Qty
148F	PLATFORM	1

Room #	Room Name	Qty
--------	-----------	-----

Room #	Room Name	Qty
--------	-----------	-----

# Bristol Forestville

## Bristol, CT

### FF and E Specifications by Item

**Item:** Music Stand **Item Code:** M-2

**Manufacturer:** Wenger **Total Quantity:** 87

**Model:** Roughneck - 037C001 **Category:** I

**Description:** All Steel Music Stand with desk-height brass spring adjuster mechanism moves and holds with one easy motion. 22-gauge steel desk with rolled edges, 18-gauge inner post and 1" w/18-gauge outer tube, 12-gauge welded steel base with wobble-free base attachment.

**Dimensions:** Desk Surface: 20" x 12½"  
Adjusts 25½" to 49" H

**Finish:** Powdercoat Paint: Black

**Power / Data:**



Room #	Room Name	Qty
146	MIDDLE SCHOOL MUSIC	26

Room #	Room Name	Qty
148F	PLATFORM	55

Room #	Room Name	Qty
148J	PRACTICE	6

**Bristol Forestville**  
**Bristol, CT**  
**FF and E Specifications by Item**

**Item:** Music-Conductor Chair **Item Code:** M-3  
**Manufacturer:** Wenger **Total Quantity:** 1  
**Model:** Conductor Chair 157D086 **Category:** I  
**Description:** Conductor Chair w/cushioned seat and back. Steel framed chair supports half-seated & half-standing posture, swivels 170 deg. & locks, combined pneumatic seat height and foot rest adjustment. 5 year warranty  
**Dimensions:** seat adjusts from 26 1/2" to 36 1/2"  
**Finish:** Frame: Black  
Upholstery: Black  
**Power / Data:**



Room #	Room Name	Qty
146	MIDDLE SCHOOL MUSIC	1

Room #	Room Name	Qty
--------	-----------	-----

Room #	Room Name	Qty
--------	-----------	-----

# Bristol Forestville

## Bristol, CT

### FF and E Specifications by Item

**Item:** Music-Conductor Stand **Item Code:** M-4  
**Manufacturer:** Wenger **Total Quantity:** 3  
**Model:** Conductor Stand-238A001 **Category:** I

**Description:** Preface Music Stand with light weight durable metal design. With curved desk and integrated storage box. Desk height brass spring adjuster mechanism moves and holds with one easy motion. Double upright posts sit in base collars, 12-gauge welded steel base with 14-gauge tie bar and wobble-free base attachment.



**Dimensions:** Music Desk: 18.5"x29"  
Storage Box: 12.5"x25"x2"  
Adjusts: 25.5"-49.5"H

**Finish:** Powdercoat Paint: Black

**Power / Data:**

Room #	Room Name	Qty
144	ELEMENTARY SCHOOL MUSIC	1

Room #	Room Name	Qty
146	MIDDLE SCHOOL MUSIC	1

Room #	Room Name	Qty
148F	PLATFORM	1

**Bristol Forestville**  
**Bristol, CT**  
**FF and E Specifications by Item**

**Item:** Music-Stand Dolly

**Item Code:** M-5

**Manufacturer:** Wenger

**Total Quantity:** 5

**Model:** Stand Cart-039C202

**Category:** I

**Description:** Large Music Stand Move & Store Cart, with center wheels and smaller outside wheels, easy grip handles, holds up to 22 Rough Neck Music Stands.

**Dimensions:** 27.5"W x 68"L

**Finish:** Finish: Standard

**Power / Data:**



Room #	Room Name	Qty
146	MIDDLE SCHOOL MUSIC	5

Room #	Room Name	Qty
--------	-----------	-----

Room #	Room Name	Qty
--------	-----------	-----

# Bristol Forestville

## Bristol, CT

### FF and E Specifications by Item

**Item:** Music-Chair Cart

**Item Code:** M-6

**Manufacturer:** Wenger

**Total Quantity:** 5

**Model:** Chair Cart-127A261

**Category:** I

**Description:** Chair Move & Store Cart - Tubular steel chair dollie with durable "easy-roll" casters, Stacks 18 Student Music chairs.

**Dimensions:**

**Finish:** Finish: Standard

**Power / Data:**



Room #	Room Name	Qty
144	ELEMENTARY SCHOOL MUSIC	3

Room #	Room Name	Qty
146	MIDDLE SCHOOL MUSIC	2

Room #	Room Name	Qty
--------	-----------	-----

# Bristol Forestville

## Bristol, CT

### FF and E Specifications by Item

---

**Item:** Upright Digital Piano with Bench

**Item Code:** M-7

**Manufacturer:** Yamaha

**Total Quantity:** 2

**Model:** Arius # YDP-V240 with bench

**Category:** I

**Description:** Yamaha Arius mobile upright Piano with bench. 88 key AWM Dynamic Stereo Sampling tone generation tech. 40 W power consumption. Graded Hammer Standard (GHS) Keyboard with Matte Black Keytops.



**Dimensions:** 53 7/8"Wx19 3/4"Dx33 9/16"H

**Finish:** Dark Rosewood

**Power / Data:**

Room #	Room Name	Qty
144	ELEMENTARY SCHOOL MUSIC	1

Room #	Room Name	Qty
148F	PLATFORM	1

Room #	Room Name	Qty
--------	-----------	-----

**Bristol Forestville**  
**Bristol, CT**  
**FF and E Specifications by Item**

**Item:** Music Lab Workstation **Item Code:** M-8  
**Manufacturer:** Wenger **Total Quantity:** 8  
**Model:** Music Lab Workstation-225C100 **Category:** I  
**Description:** Fixed Height Keyboarding Workstation  
 Heavy duty 14-gauge steel frame with reinforced desk top. 3/4" plywood top and back panels & 3/4" industrial-grade composite wood on sides with durable polyester laminate finish. With Accessories: 6-outlet Power strip, wir/cable clips.  
**Dimensions:** 49 1/2"W x 32"D x 39"OH 30" H Work Surface  
**Finish:** Plastic Laminate: Fusion Maple  
 Metal: Oyster  
**Power / Data:** 6 outlet Power Strip Synth. Packed



Room #	Room Name	Qty
146	MIDDLE SCHOOL MUSIC	8

Room #	Room Name	Qty
--------	-----------	-----

Room #	Room Name	Qty
--------	-----------	-----

**Bristol Forestville**  
**Bristol, CT**  
**FF and E Specifications by Item**

**Item:** Music - Percussion Workstation

**Item Code:** M-9

**Manufacturer:** Wenger

**Total Quantity:** 1

**Model:** Percussion Workstation-147G001-102

**Category:** I

**Description:** Percussion Workstation with Accessories - Lockable mobile storage and work area for percussion instruments, with padded top, 4 heavy duty casters, 4 foam lined drawers and large lower cabinets.

**Dimensions:** 48"Wx24"D

**Finish:** Finish: Wenger Fusion Maple, Almond interior

**Power / Data:**



Room #	Room Name	Qty
146	MIDDLE SCHOOL MUSIC	1

Room #	Room Name	Qty
--------	-----------	-----

Room #	Room Name	Qty
--------	-----------	-----

# Bristol Forestville

## Bristol, CT

### FF and E Specifications by Item

**Item:** Double Lock Medicine Cabinet

**Item Code:** N-1

**Manufacturer:** School Health

**Total Quantity:** 1

**Model:** 42002

**Category:** U

**Description:** Narcotics Cabinet - Double-door protection for narcotics with 2 adjustable, removable shelves and an individual key for each door - Wall mounted - location TBD.

**Dimensions:** 9.5"Wx4"Dx14.5"H

**Finish:** Grey

**Power / Data:**



Room #	Room Name	Qty
163F	OFFICE	1

Room #	Room Name	Qty
--------	-----------	-----

Room #	Room Name	Qty
--------	-----------	-----

# Bristol Forestville

## Bristol, CT

### FF and E Specifications by Item

---

**Item:** Exam Table **Item Code:** N-2

**Manufacturer:** School Health **Total Quantity:** 2

**Model:** 24-186 **Category:** U

**Description:** Delux Exam Table with fully padded top, paper roller, enclosed storage below.

**Dimensions:**

**Finish:**

**Power / Data:**

Room #	Room Name	Qty
163E	EXAM	1

Room #	Room Name	Qty
163G	EXAM	1

Room #	Room Name	Qty
--------	-----------	-----

**Bristol Forestville**  
**Bristol, CT**  
**FF and E Specifications by Item**

**Item:** Exam Stool

**Item Code:** N-3

**Manufacturer:** School Health

**Total Quantity:** 3

**Model:** 240008

**Category:** U

**Description:** Pneumatic Revolving Exam Stool with foot adjustment. Wide Base with 5 casters.

**Dimensions:** Adjusts from 15"-20.5"H

**Finish:** Black

**Power / Data:**



Room #	Room Name	Qty
163D	ES RESTING	1

Room #	Room Name	Qty
163E	EXAM	1

Room #	Room Name	Qty
163G	EXAM	1

**Bristol Forestville**  
**Bristol, CT**  
**FF and E Specifications by Item**

**Item:** Physician Beam Scale

**Item Code:** N-4

**Manufacturer:** Moore Medical

**Total Quantity:** 2

**Model:** Healthometer-32150

**Category:** U

**Description:** The 402KL Physicians Beam Scale features:  
 Rotating poise bars for dual reading of pounds and kilograms Poise bar lock-in for error-free operation Permanent, engraved readings on poise bar for long-lasting readability Heavy-duty steel base for improved strength and durability Professional Silent Slide® height rod for smooth, quiet operation ABS plastic platform cover for easy cleaning Factory calibrated to ensure accuracy Includes 150 lb and 40 kg counterweights to increase capacity to 500 lb/200 kg Assembly required 2 Year Limited Warranty 500 lb/200 kg capacity. With Height Rod



**Dimensions:** Dual-read height rod range 24" to 84" (by 1/8 in.), 60 cm to 213 cm (by 1 mm)

**Finish:** Std

**Power / Data:**

Room #	Room Name	Qty
163	WAITING	1

Room #	Room Name	Qty
163G	EXAM	1

Room #	Room Name	Qty
--------	-----------	-----

**Bristol Forestville**  
**Bristol, CT**  
**FF and E Specifications by Item**

**Item:** Recovery Cot **Item Code:** N-5  
**Manufacturer:** School Health **Total Quantity:** 4  
**Model:** 24533OPT **Category:** U  
**Description:** Varsity Recovery Couch With built-in headrest adds 6 1/2" in height over body cushion.



**Dimensions:** 72" L x 27" W x 20" H  
 headrest adds 6 1/2" in height over body cushion

**Finish:** Dark Blue Vinyl  
 Solid Wood Legs

**Power / Data:**

Room #	Room Name	Qty
163B	MS RESTING	2

Room #	Room Name	Qty
163D	ES RESTING	2

Room #	Room Name	Qty
--------	-----------	-----

# Bristol Forestville

## Bristol, CT

### FF and E Specifications by Item

**Item:** Shelving Range - Mobile Double Face

**Item Code:** R-1

**Manufacturer:** MJ-3000 & Worden

**Total Quantity:** 2

**Model:** Shelving Range Semi-Custom Configuration

**Category:** G

**Description:** **Double Face Steel Cantilevered Shelves:**  
 Double face starter (1) with (2) adders ea 42"h x 36"w x 20"d with 18 flat shelves (9 per side) w/integral backs, 1 sliding wire book support/shelf. Modify shelving units for semi-consealed locking casters.

**End Panels on Two Ends:**  
 1-1/4" Thick clear maple wood veneer end panel with solid clear maple hard wood eased edges, 1 1/4" wide @ vertical edges, 2" wide @ top edge, and 4" wide @ bottom edge.

**Canopy Top:** 1-1/4" Thick HPL face banded with 1-1/4" hard wood maple with eased edges on two long sides, brown backer under.

**Note:** Include all brackets and hardware for safe & secure installation. Provide letter from manufacturer re:safety and stability of rolling stacks as configured.

**Dimensions:** +/-111"Wx24"Dx42"H Overall nominal size of assembly  
 Refer to Floor Plans

**Finish:** Steel Shelving: Powdercoat - Color- 2205 Light Gray  
 Wood End Panels and Edges: Clear Maple, Match Architect's Sample  
 Plastic Laminate Top: Wilsonart 10776-60 "Kensington Maple"



**Power / Data:**

Room #	Room Name	Qty
100	MEDIA CENTER	2

Room #	Room Name	Qty
--------	-----------	-----

Room #	Room Name	Qty
--------	-----------	-----

**Bristol Forestville**  
**Bristol, CT**  
**FF and E Specifications by Item**

**Item:** Shelving Range - Single Face

**Item Code:** R-10

**Manufacturer:** MJ-3000 & Worden

**Total Quantity:** 1

**Model:** Shelving Range Semi-Custom Configuration

**Category:** G

**Description:** **Single Face Steel Cantilevered Shelves - L-Shape Configuration:**  
 (2) 78"Hx36"Wx10"D Single face starters w/6 10"D integral back shelves per section, (11) 78"Hx36"Wx10"D single face adders w/6 10"D integral back shelves per section and (1) 78"Hx30"Wx10"D single face adder w/6 10"D integral shelves (84- flat integral shelves total) & 1 sliding wire book support/shelf.

**End Panels on Two Ends & Corner Filler:**  
 1-1/4" Thick clear maple wood veneer end panel with solid clear maple hard wood eased edges, 1 1/4" wide @ vertical edges, 2" wide @ top edge, and 4" wide @ bottom edge.

**Canopy Top:** L-Shape - 1-1/4" Thick HPL face banded with 1-1/4" hard wood maple with eased edges on two long sides, brown backer under.

**Note:** Include all brackets and hardware for safe & secure installation.



**Dimensions:** L Shape 216"Wx12"Dx78"H and 282"Wx12"Dx78"H  
 Overall nominal size of assembly  
 Refer to Floor Plans V.I.F.

**Finish:** Steel Shelving: Powdercoat - Color- 2205 Light Gray  
 Wood End Panels and Edges: Clear Maple, Match Architect's Sample  
 Plastic Laminate Top: Wilsonart 10776-60 "Kensington Maple"

**Power / Data:**

Room #	Room Name	Qty
100	MEDIA CENTER	1

Room #	Room Name	Qty
--------	-----------	-----

Room #	Room Name	Qty
--------	-----------	-----

# Bristol Forestville

## Bristol, CT

### FF and E Specifications by Item

**Item:** Shelving Range - Single Face

**Item Code:** R-11

**Manufacturer:** MJ-3000 & Worden

**Total Quantity:** 1

**Model:** Shelving Range Semi-Custom Configuration

**Category:** G

**Description:** **Single Face Steel Cantilevered Shelves - U-Shape Configuration:**  
 (3) 78"Hx36"Wx10"D Single face starters w/6 10"D integral shelves per section, (9) 78"Hx36"Wx10"D single face adders w/6 10"D integral shelves per section and (1) 42"Hx30"Wx10"D single face starter w/3 10" integral shelves, 1 sliding wire book support/shelf (72 total).

**End Panels on Two Ends, 2 Corner Fillers & Back Panel for Free Standing Single Face:**

1-1/4" Thick clear maple wood veneer end panel with solid clear maple hard wood eased edges, 1 1/4" wide @ vertical edges, 2" wide @ top edge, and 4" wide @ bottom edge.

**Canopy Tops:** 1-1/4" Thick HPL face banded with 1-1/4" hard wood maple with eased edges on two long sides, brown backer under. U - Shape @ 78"H and Straight Section @ 42"H Free Standing Section.

**Note:** Include all brackets and hardware for safe & secure installation.



**Dimensions:** U Shape 180"Wx12"Dx78"H, 144"Wx12"Dx78"H, 108"Wx12"Dx78"H and 30"Wx12"Dx42"H  
 Overall nominal size of assembly Refer to Floor Plans V.I.F.

**Finish:** Steel Shelving: Powdercoat - Color- 2205 Light Gray  
 Wood End Panels and Edges: Clear Maple, Match Architect's Sample  
 Plastic Laminate Top: Wilsonart 10776-60 "Kensington Maple"

**Power / Data:**

Room #	Room Name	Qty
100C	LITERACY	1

Room #	Room Name	Qty

Room #	Room Name	Qty

# Bristol Forestville

## Bristol, CT

### FF and E Specifications by Item

**Item:** Shelving Range - Single Face

**Item Code:** R-2

**Manufacturer:** MJ-3000 & Worden

**Total Quantity:** 3

**Model:** Shelving Range Semi-Custom Configuration

**Category:** G

**Description:** **Single Face Steel Cantilevered Shelves:**  
 (1) 42"Hx36"Wx10"D Single face starter w/3 10"D integral back shelves per section & 1 sliding wire book support/shelf.

**End Panels on Two Ends**

1-1/4" Thick clear maple wood veneer end panel with solid clear maple hard wood eased edges, 1 1/4" wide @ vertical edges, 2" wide @ top edge, and 4" wide @ bottom edge.

**Canopy Top:** 1-1/4" Thick HPL face banded with 1-1/4" hard wood maple with eased edges on two long sides, brown backer under. Wood finished back panel where unit is freestanding.

**Note:** Include all brackets and hardware for safe & secure installation.



**Dimensions:** 36"Wx12"Dx42"H  
 Overall nominal size of assembly Refer to Floor Plans V.I.F.

**Finish:** Steel Shelving: Powdercoat - Color- 2205 Light Gray  
 Wood End Panels and Edges: Clear Maple, Match Architect's Sample  
 Plastic Laminate Top: Wilsonart 10776-60 "Kensington Maple"

**Power / Data:**

Room #	Room Name	Qty
100	MEDIA CENTER	2

Room #	Room Name	Qty
100A	CIRCULATION	1

Room #	Room Name	Qty
--------	-----------	-----

# Bristol Forestville

## Bristol, CT

### FF and E Specifications by Item

**Item:** Shelving Range - Double Face

**Item Code:** R-3

**Manufacturer:** MJ-3000 & Worden

**Total Quantity:** 2

**Model:** Shelving Range Semi-Custom Configuration

**Category:** G

**Description:** **Double Face Steel Cantilevered Shelves:**  
 (1)42"h x 36"w x 20"d Starter unit with (3) 10" integral shelves per side, Starter unit includes two column assemblies, cross bars, kick plate, integral back shelves and end brackets, Include book sliding wire book supports for each shelf and bracket for wood canopy top support.  
**End Panels on Two Ends** 1-1/4" Thick clear maple wood veneer end panel with solid clear maple hard wood eased edges, 1 1/4" wide @ vertical edges, 2" wide @ top edge, and 4" wide @ bottom edge.  
**Canopy Top:** 1-1/4" Thick HPL face banded with 1-1/4" hard wood maple with eased edges on two long sides, brown backer under.  
**Note:** Include all brackets and hardware for safe & secure installation



**Dimensions:** 36"Wx24"Dx42"H  
 Overall nominal size of assembly Refer to Floor Plans V.I.F.

**Finish:** Steel Shelving: Powdercoat - Color- 2205 Light Gray  
 Wood End Panels and Edges: Clear Maple, Match Architect's Sample  
 Plastic Laminate Top: Wilsonart 10776-60 "Kensington Maple"

**Power / Data:**

Room #	Room Name	Qty
100	MEDIA CENTER	2

Room #	Room Name	Qty
--------	-----------	-----

Room #	Room Name	Qty
--------	-----------	-----

# Bristol Forestville

## Bristol, CT

### FF and E Specifications by Item

**Item:** Shelving Range - Single & Double Fac

**Item Code:** R-4

**Manufacturer:** MJ-3000 & Worden

**Total Quantity:** 1

**Model:** Shelving Range Semi-Custom Configuration

**Category:** G

**Description:** **Double Face Steel Cantilevered Shelf:**  
 (1) 42"h x 36"w x 28"d starter unit with (2) 14"d hinged display and storage shelves per face attached to single face shelving area as peninsula.  
**Single Face Steel Cantilevered Shelves:**  
 (1) 42"Hx36"Wx14"D Single face starter w/2 14"D hinged display and storage shelves per section, (3) 42"Hx36"Wx14"D single face adders w/2 14"D hinged display and storage shelves per section  
**End Panels on Two Ends**  
 1-1/4" Thick clear maple wood veneer end panel with solid clear maple hard wood eased edges, 1 1/4" wide @ vertical edges, 2" wide @ top edge, and 4" wide @ bottom edge.  
**Canopy Top:** 1-1/4" Thick HPL face banded with 1-1/4" hard wood maple with eased edges on two long sides, brown backer under.  
**Note:** Include all brackets and hardware for safe & secure installation.



**Dimensions:** 144"Wx12"-24"Dx42"H  
 Overall nominal size of assembly Refer to Floor Plans V.I.F.

**Finish:** Steel Shelving: Powder coat - Color- 2205 Light Gray  
 Wood End Panels and Edges: Clear Maple, Match Architect's Sample  
 Plastic Laminate Top: Wilsonart 10776-60 "Kensington Maple"

**Power / Data:**

Room #	Room Name	Qty
100B	OPAC	1

Room #	Room Name	Qty
--------	-----------	-----

Room #	Room Name	Qty
--------	-----------	-----

# Bristol Forestville

## Bristol, CT

### FF and E Specifications by Item

**Item:** Shelving Range - Double Face  
**Manufacturer:** MJ-3000 & Worden  
**Model:** Shelving Range Semi-Custom Configuration

**Item Code:** R-5  
**Total Quantity:** 2  
**Category:** G



**Description:** **Double Face Steel Cantilevered Shelves:**  
 (1) 66"h x 36"w x 20"d double face starter with (2) adders each with (5) 10"d integral shelves per face, sliding wire book supports  
**End Panels on Two Ends:**  
 1-1/4" Thick clear maple wood veneer end panel with solid clear maple hard wood eased edges, 1 1/4" wide @ vertical edges, 2" wide @ top edge, and 4" wide @ bottom edge.  
**Canopy Top:** 1-1/4" Thick HPL face banded with 1-1/4" hard wood maple with eased edges on two long sides, brown backer under.  
**Note:** Include all brackets and hardware for safe & secure installation.

**Dimensions:** 108"Wx24"Dx66"H  
 Overall nominal size of assembly Refer to Floor Plans V.I.F.

**Finish:** Steel Shelving: Powdercoat - Color- 2205 Light Gray  
 Wood End Panels and Edges: Clear Maple, Match Architect's Sample  
 Plastic Laminate Top: Wilsonart 10776-60 "Kensington Maple"

**Power / Data:**

Room #	Room Name	Qty
100	MEDIA CENTER	2

Room #	Room Name	Qty
--------	-----------	-----

Room #	Room Name	Qty
--------	-----------	-----

# Bristol Forestville

## Bristol, CT

### FF and E Specifications by Item

**Item:** Shelving Range - Double Face  
**Manufacturer:** MJ-3000 & Worden  
**Model:** Shelving Range Semi-Custom Configuration

**Item Code:** R-6  
**Total Quantity:** 6  
**Category:** G



**Description:** **Double Face Steel Cantilevered Shelves:**  
 (1) 60"h x 36"w x 20"d double face starter with (2) adders each with (4) 10"d integral shelves per face, sliding wire book supports  
**End Panels on Two Ends:**  
 1-1/4" Thick clear maple wood veneer end panel with solid clear maple hard wood eased edges, 1 1/4" wide @ vertical edges, 2" wide @ top edge, and 4" wide @ bottom edge.  
**Canopy Top:** 1-1/4" Thick HPL face banded with 1-1/4" hard wood maple with eased edges on two long sides, brown backer under.  
**Note:** Include all brackets and hardware for safe & secure installation.

**Dimensions:** 108"Wx24"Dx60"H  
 Overall nominal size of assembly Refer to Floor Plans V.I.F.

**Finish:** Steel Shelving: Powdercoat - Color- 2205 Light Gray  
 Wood End Panels and Edges: Clear Maple, Match Architect's Sample  
 Plastic Laminate Top: Wilsonart 10776-60 "Kensington Maple"

**Power / Data:**

Room #	Room Name	Qty
100	MEDIA CENTER	6

Room #	Room Name	Qty
--------	-----------	-----

Room #	Room Name	Qty
--------	-----------	-----

# Bristol Forestville

## Bristol, CT

### FF and E Specifications by Item

**Item:** Shelving Range - Double Face

**Item Code:** R-7

**Manufacturer:** MJ-3000 & Worden

**Total Quantity:** 6

**Model:** Shelving Range Custom Config

**Category:** G

**Description:** **Double Face Steel Cantilevered Shelves:**  
 (1) 42"h x 36"w x 20"d double face starter and (2) Adder units with (3) 10"d integral shelves per side, Starter unit includes two column assemblies, cross bars, kick plate, integral back shelves and end brackets, adder unit is the same as starter except it includes only one column assembly. Include book sliding wire book supports for each shelf and bracket for wood canopy top support. Include all brackets and hardware for safe & secure installation.  
**End Panels on Two Ends:**  
 1-1/4" Thick clear maple wood veneer end panel with solid clear maple hard wood eased edges, 1 1/4" wide @ vertical edges, 2" wide @ top edge, and 4" wide @ bottom edge.  
**Canopy Top:** 1-1/4" Thick HPL face banded with 1-1/4" hard wood maple with eased edges on two long sides, brown backer under.  
**Note:** Include all brackets and hardware for safe & secure installation.



**Dimensions:** 108"Wx24"Dx42"H  
 Overall nominal size of assembly Refer to Floor Plans V.I.F.

**Finish:** Steel Shelving: Powder coat - Color-2205 Light Gray  
 Wood End Panels and Edges: Clear Maple, Match Architect's Sample  
 Plastic Laminate Top: Wilsonart 10776-60 "Kensington Maple"

**Power / Data:**

Room #	Room Name	Qty
100	MEDIA CENTER	6

Room #	Room Name	Qty
--------	-----------	-----

Room #	Room Name	Qty
--------	-----------	-----

**Bristol Forestville**  
**Bristol, CT**  
**FF and E Specifications by Item**

**Item:** Shelving Range - Single Face

**Item Code:** R-8

**Manufacturer:** MJ-3000 & Worden

**Total Quantity:** 1

**Model:** Shelving Range Semi-Custom Configuration

**Category:** G

**Description:** **Single Face Steel Cantilevered Shelves:**  
 (1) 78"Hx36"Wx10"D Single face starter w/6 10"D integral back shelves per section, (5) 78"Hx36"Wx10"D single face adders w/6 10"D integral back shelves per section & 1 sliding wire book support/shelf.  
**End Panels on Two Ends**  
 1-1/4" Thick clear maple wood veneer end panel with solid clear maple hard wood eased edges, 1 1/4" wide @ vertical edges, 2" wide @ top edge, and 4" wide @ bottom edge.  
**Canopy Top:** 1-1/4" Thick HPL face banded with 1-1/4" hard wood maple with eased edges on two long sides, brown backer under.  
**Note:** Include all brackets and hardware for safe & secure installation.



**Dimensions:** 217"Wx12"Dx78"H  
 Overall nominal size of assembly Refer to Floor Plans V.I.F.

**Finish:** Steel Shelving: Powdercoat - Color- 2205 Light Gray  
 Wood End Panels and Edges: Clear Maple, Match Architect's Sample  
 Plastic Laminate Top: Wilsonart 10776-60 "Kensington Maple"

**Power / Data:**

Room #	Room Name	Qty
100	MEDIA CENTER	1

Room #	Room Name	Qty
--------	-----------	-----

Room #	Room Name	Qty
--------	-----------	-----

**Bristol Forestville**  
**Bristol, CT**  
**FF and E Specifications by Item**

**Item:** Shelving Range - Single Face

**Item Code:** R-9

**Manufacturer:** MJ-3000 & Worden

**Total Quantity:** 1

**Model:** Shelving Range Semi-Custom Configuration

**Category:** G

**Description:** **Single Face Steel Cantilevered Shelves:**  
 (1) 78"Hx36"Wx10"D Single face starter w/6 10"D integral back shelves per section, (3) 78"Hx36"Wx10"D single face adders w/6 10"D integral back shelves per section & 1 sliding wire book support/shelf.  
**End Panels on Two Ends**  
 1-1/4" Thick clear maple wood veneer end panel with solid clear maple hard wood eased edges, 1 1/4" wide @ vertical edges, 2" wide @ top edge, and 4" wide @ bottom edge.  
**Canopy Top:** 1-1/4" Thick HPL face banded with 1-1/4" hard wood maple with eased edges on two long sides, brown backer under.  
**Note:** Include all brackets and hardware for safe & secure installation.



**Dimensions:** 144"Wx12"Dx78"H  
 Overall nominal size of assembly Refer to Floor Plans V.I.F.

**Finish:** Steel Shelving: Powdercoat - Color- 2205 Light Gray  
 Wood End Panels and Edges: Clear Maple, Match Architect's Sample  
 Plastic Laminate Top: Wilsonart 10776-60 "Kensington Maple"

**Power / Data:**

Room #	Room Name	Qty
100	MEDIA CENTER	1

Room #	Room Name	Qty
--------	-----------	-----

Room #	Room Name	Qty
--------	-----------	-----

# Bristol Forestville

## Bristol, CT

### FF and E Specifications by Item

---

**Item:** Safe **Item Code:** S-1  
**Manufacturer:** Sentry (Staples) **Total Quantity:** 2  
**Model:** Model # 429184-D880 **Category:** B  
**Description:** 4.3 CU ft Capacity Security Safe for School Administration and Kitchen.  
**Dimensions:** 22"Wx19.5"Dx28"H  
**Finish:** Finish: TBS from full manufacturer's finish range.

**Power / Data:**

Room #	Room Name	Qty
114	FILE ROOM	1

Room #	Room Name	Qty
234A	OFFICE	1

Room #	Room Name	Qty
--------	-----------	-----

**Bristol Forestville**  
**Bristol, CT**  
**FF and E Specifications by Item**

**Item:** Floor & Wall Mat **Item Code:** SP-1  
**Manufacturer:** Abilations - Sportime **Total Quantity:** 7  
**Model:** #012166 & #003826 **Category:** U  
**Description:** 4'x6' Mat w/hook & loop on 4 sides & with 4'W Hook & Loop Wall Fastener Strip.  
**Dimensions:** 4'x6' Sections with 2' Folds  
 4' Wide Hook & Loop Wall Fastener Strips  
**Finish:** Colors: Blue & Yellow  
**Power / Data:**



Room #	Room Name	Qty
130	OT/PT	5

Room #	Room Name	Qty
219	ES SPECIAL ED	2

Room #	Room Name	Qty
--------	-----------	-----

# Bristol Forestville

## Bristol, CT

### FF and E Specifications by Item

**Item:** Storage Stool **Item Code:** ST-1  
**Manufacturer:** Lakeshore **Total Quantity:** 55  
**Model:** FF626 **Category:** D  
**Description:** Classroom-Tough Storage Stool with shelves, cushion top and storage sack.  
**Dimensions:** 16"Wx16"Dx18.5"H  
**Finish:** Hardwood - Birch  
 Cushion - TBS from manufacturers full color range.



**Power / Data:**

Room #	Room Name	Qty
123	CLASSROOM	1
126	CLASSROOM	1
136	CLASSROOM	1
139	CLASSROOM	1
224	CLASSROOM	1
238	ENGINEERING TECH LAB	26
212	CLASSROOM	1
215	CLASSROOM	1
219	ES SPECIAL ED	1
229	CLASSROOM	1

Room #	Room Name	Qty
124	CLASSROOM	1
127	CLASSROOM	1
137	CLASSROOM	1
221	CLASSROOM	2
225	CLASSROOM	1
209	CLASSROOM	1
213	CLASSROOM	1
216	CLASSROOM	1
227	CLASSROOM	1
231	CLASSROOM	1

Room #	Room Name	Qty
125	CLASSROOM	1
135	CLASSROOM	1
138	CLASSROOM	1
223	CLASSROOM	1
226	CLASSROOM	1
211	CLASSROOM	1
214	CLASSROOM	1
217	CLASSROOM	1
228	CLASSROOM	1

# Bristol Forestville

## Bristol, CT

### FF and E Specifications by Item

**Item:** Flip Top Table with Casters

**Item Code:** T-1

**Manufacturer:** Fixtures

**Total Quantity:** 42

**Model:** Dewey - LNTR2460TFCS

**Category:** A-1

**Description:** Table with folding top, and legs that nest to make it more compact during storage. 1 1/8" thick high pressure laminate, particle board core w/steel support channel for level worksurface, edged and backed with moisture-resistant covering to form completely sealed outside surface, urethane edge, C-legs with hard floor type locking casters.

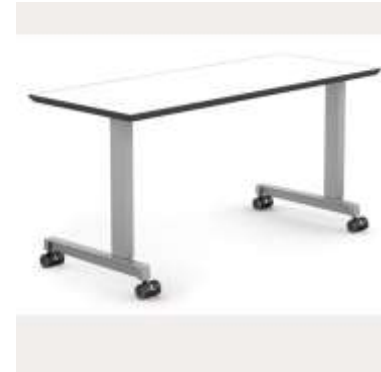

**Dimensions:** 60"Wx24"Dx29"H

**Finish:**  
 Frame/Legs: E-06 Satin Silver  
 P-Lam Top & Modesty: Wilsonart Fusion Maple  
 Edge: Urethane - U04 - Dolphin

**Power / Data:** Include (1 )centered grommet  
 Horizontal Wire Management  
 Vertical Wire Management @ leg adjacent to power source

Room #	Room Name	Qty
158	CLASSROOM	14

Room #	Room Name	Qty
246	CLASSROOM	14

Room #	Room Name	Qty
306	CLASSROOM	14

# Bristol Forestville

## Bristol, CT

### FF and E Specifications by Item

---

**Item:** Art Demo Table

**Item Code:** T-10

**Manufacturer:** Diversified Woodcraft

**Total Quantity:** 1

**Model:** P7176M30N

**Category:** C-2

**Description:** Plain Apron Table with Maple Legs & Aprons and Epoxy Top. Steel reinforced construction.

**Dimensions:** 48"Wx36"Dx30"H

**Finish:** Wood: Maple  
Top: Black Epoxy



**Power / Data:**

Room #	Room Name	Qty
121	ELEMENTARY ART ROOM	1

Room #	Room Name	Qty
--------	-----------	-----

Room #	Room Name	Qty
--------	-----------	-----

# Bristol Forestville

## Bristol, CT

### FF and E Specifications by Item

---

**Item:** Table/Desk **Item Code:** T-16

**Manufacturer:** Gunlocke **Total Quantity:** 4

**Model:** Trio Training Table - ADA **Category:** A-1

**Description:** Trio Training Table with half modesty and T-base with glides, plastic laminate top with knife edge. Include ganging device.

**Dimensions:** 48"Wx30"Dx29.5"H ADA Accessible

**Finish:** Plastic Laminate: Natural Maple  
Legs& Grommet: Silver

**Power / Data:** One Center Grommet & Wire Manager Under Worksurface



Room #	Room Name	Qty
103	PSYCH.	1
111	AP	1

Room #	Room Name	Qty
104	PSYCH.	1

Room #	Room Name	Qty
105	GUIDANCE COUNCELOR	1

# Bristol Forestville

## Bristol, CT

### FF and E Specifications by Item

**Item:** Desk Run Off **Item Code:** T-17

**Manufacturer:** Gunlocke **Total Quantity:** 1

**Model:** Trio (Special) ADA **Category:** A-1

**Description:** Office Conference Top - Run Off with 2 legs, 1 grommet, horizontal wire management, and modesty panel. Plastic laminate top with square wood edge.

**Dimensions:** 42"Wx30"Dx29.25 ADA Accessible

**Finish:** Plastic Laminate: Natural Maple  
Wood: Natural Maple  
Legs: Silver



**Power / Data:**

Room #	Room Name	Qty
112	AP	1

Room #	Room Name	Qty
--------	-----------	-----

Room #	Room Name	Qty
--------	-----------	-----

# Bristol Forestville

## Bristol, CT

### FF and E Specifications by Item

---

**Item:** Table/Desk **Item Code:** T-18

**Manufacturer:** Gunlocke **Total Quantity:** 1

**Model:** TrioTraining Table ADA **Category:** A-1

**Description:** Trio Training Table with half modesty and T-base with glides, plastic laminate top with knife edge. Include ganging device.

**Dimensions:** 60"Wx30"Dx29.5"H ADA Accessible

**Finish:** Wood: Natural Maple  
Legs & Grommet: Silver

**Power / Data:** One Center Grommet & Wire Manager Under Worksurface



Room #	Room Name	Qty
167	OFFICE	1

Room #	Room Name	Qty
--------	-----------	-----

Room #	Room Name	Qty
--------	-----------	-----

# Bristol Forestville

## Bristol, CT

### FF and E Specifications by Item

**Item:** Small Group Reading Table

**Item Code:** T-2

**Manufacturer:** Smith System

**Total Quantity:** 50

**Model:** Interchange Activity Table - ADA

**Category:** C-2

**Description:** Half Moon Shape Activity Table - 1 1/4" thick high density particle board double sided with .30" HPL surfaces and mechanically fastened 3/8" bumper T-mold edge. Tops are pre-drilled for leg set attachment and are supported by one or more 2"x3" channels with 4 breakovers for optimum strength. 1" increment height adjustable ellipse legs constructed of 16ga stems & inserts, 14ga cross braces & 12ga plates w/each leg height secured by two 3/8" set screws. Legs terminate with sock style glide caps and large fine tune adjustable leveling, hard floor type glides.



**Dimensions:** 36"D x 72"Wx22-34"H ADA clearance (center of Student Side)

**Finish:** Top: Plastic Laminate - Wilsonart Fusion Maple  
Edge: Platinum  
Frame & Legs: Platinum

**Power / Data:**

Room #	Room Name	Qty
123	CLASSROOM	1
126	CLASSROOM	1
132	SMALL GROUP	1
136	CLASSROOM	1
139	CLASSROOM	1
161	CLASSROOM	1
205	SMALL GROUP 5	1
212	CLASSROOM	1
215	CLASSROOM	1
219	ES SPECIAL ED	2
224	CLASSROOM	1

Room #	Room Name	Qty
124	CLASSROOM	1
127	CLASSROOM	1
133	SMALL GROUP	1
137	CLASSROOM	1
154	CLASSROOM	1
201	MS SPECIAL ED	1
209	CLASSROOM	1
213	CLASSROOM	1
216	CLASSROOM	1
221	CLASSROOM	1
225	CLASSROOM	1

Room #	Room Name	Qty
125	CLASSROOM	1
131	SMALL GROUP	1
135	CLASSROOM	1
138	CLASSROOM	1
160	CLASSROOM	1
204	SMALL GROUP 4	1
211	CLASSROOM	1
214	CLASSROOM	1
217	CLASSROOM	1
223	CLASSROOM	1
226	CLASSROOM	1

**Bristol Forestville**  
**Bristol, CT**  
**FF and E Specifications by Item**

227	CLASSROOM	1
231	CLASSROOM	1
248	CLASSROOM	1
252	SMALL GROUP 2	1
302	CLASSROOM	1
309	CLASSROOM	1

228	CLASSROOM	1
240	CLASSROOM	1
250	CLASSROOM	1
253	SMALL GROUP 3	1
303	CLASSROOM	1

229	CLASSROOM	1
241	CLASSROOM	1
251	SMALL GROUP 1	1
254	WORLD LANGUAGE	1
308	CLASSROOM	1

# Bristol Forestville

## Bristol, CT

### FF and E Specifications by Item

---

**Item:** Conference Table

**Item Code:** T-20

**Manufacturer:** Gunlocke

**Total Quantity:** 1

**Model:** Trio - ADA

**Category:** A-1

**Description:** Rectangular Table with 2 Cylindar Bases and plastic laminate table top with square wood edge.



**Dimensions:** 96"Wx48"Dx29"H ADA Accessible

**Finish:** Plastic Laminate - Natural Maple  
Wood: Natural Maple

**Power / Data:** Center Grommet - No Power, Silver

Room #	Room Name	Qty
102	CONFERENCE ROOM	1

Room #	Room Name	Qty
--------	-----------	-----

Room #	Room Name	Qty
--------	-----------	-----

# Bristol Forestville

## Bristol, CT

### FF and E Specifications by Item

**Item:** Conference Table **Item Code:** T-21

**Manufacturer:** Gunlocke **Total Quantity:** 1

**Model:** Medley, ADA **Category:** A-1

**Description:** Boat Shaped Conference Table w/3 cylinder bases and softened wood edge.

**Dimensions:** 120"Wx48"Dx29"H ADA Accessible

**Finish:** Plastic Laminate: Natural Maple  
Wood: Natural Maple

**Power / Data:** One Centered Wired Power & Data Center, Silver



Room #	Room Name	Qty
108	CONFERENCE ROOM	1

Room #	Room Name	Qty
--------	-----------	-----

Room #	Room Name	Qty
--------	-----------	-----

**Bristol Forestville**  
**Bristol, CT**  
**FF and E Specifications by Item**

**Item:** Computer Table **Item Code:** T-23  
**Manufacturer:** Smith System **Total Quantity:** 14  
**Model:** UXL XL2472 AL & 17044 - ADA **Category:** C-2  
**Description:** Computer Table with full width wire manager. 3/4" thick high density particle board double sided with .30" HPL surfaces and mechanically fastened 3/8" bumper T-mold edge. Straight - adjustable height steel tubular powdercoated legs with glides.  
**Dimensions:** 72"Wx24"DxAdj. 27"-33"H ADA Accessible  
**Finish:** Top: Plastic Laminate - Wilsonart Fusion Maple  
Edge: Gray  
Frame & Legs: Platinum



**Power / Data:**

Room #	Room Name	Qty
117	COMPUTER ROOM	13

Room #	Room Name	Qty
157	HEALTH	1

Room #	Room Name	Qty
--------	-----------	-----

**Bristol Forestville**  
**Bristol, CT**  
**FF and E Specifications by Item**

**Item:** Computer Table

**Item Code:** T-24

**Manufacturer:** Smith System

**Total Quantity:** 1

**Model:** UXL XL2436 AL & 17041 - ADA

**Category:** C-2

**Description:** Computer Table with full width wire manager. 3/4" thick high density particle board double sided with .30" HPL surfaces and mechanically fastened 3/8" bumper T-mold edge. Straight - adjustable height steel tubular powdercoated legs with glides.



**Dimensions:** 36"Wx24"DxAdj. 27"-33"H ADA Accessible

**Finish:** Top: Plastic Laminate - Wilsonart Fusion Maple  
 Edge: Grey  
 Frame & Legs: Platinum

**Power / Data:**

Room #	Room Name	Qty
148J	PRACTICE	1

Room #	Room Name	Qty
--------	-----------	-----

Room #	Room Name	Qty
--------	-----------	-----

# Bristol Forestville

## Bristol, CT

### FF and E Specifications by Item

**Item:** Student Table-Adjustable Height

**Item Code:** T-3

**Manufacturer:** Smith System

**Total Quantity:** 65

**Model:** Interchange Activity Table - ADA

**Category:** C-2

**Description:** Rectangular Activity Table - 1 1/4" thick high density particle board double sided with .30" HPL surfaces and mechanically fastened 3/8" bumper T-mold edge. Tops are pre-drilled for leg set attachment and are supported by one or more 2"x3" channels with 4 breakovers for optimum strength. 1" increment height adjustable ellipse legs constructed of 16ga stems & inserts, 14ga cross braces & 12ga plates w/each leg height secured by two 3/8" set screws. Legs terminate with sock style glide caps and large fine tune adjustable leveling, hard floor type glides.



**Dimensions:** 24"Dx 48"Wx22"-34"H ADA clearance

**Finish:** Top: Plastic Laminate - Wilsonart Fusion Maple  
Edge: Blueberry  
Frame & Legs: Platinum

**Power / Data:**

Room #	Room Name	Qty
123	CLASSROOM	11
126	CLASSROOM	11
136	CLASSROOM	1
139	CLASSROOM	1
224	CLASSROOM	1

Room #	Room Name	Qty
124	CLASSROOM	11
127	CLASSROOM	11
137	CLASSROOM	1
221	CLASSROOM	1
225	CLASSROOM	1

Room #	Room Name	Qty
125	CLASSROOM	11
135	CLASSROOM	1
138	CLASSROOM	1
223	CLASSROOM	1
226	CLASSROOM	1

# Bristol Forestville

## Bristol, CT

### FF and E Specifications by Item

**Item:** Science Demo Table

**Manufacturer:** Diversified Woodcrafters

**Model:** 4352FK - ADA

**Description:** Mobile Demo Table - ADA Accessible

.

**Dimensions:** 72"Wx24"Dx33"H ADA Accessible

**Finish:** Wood: Oak  
Top: Black Epoxy Resin

**Item Code:** T-4

**Total Quantity:** 4

**Category:** C-2



**Power / Data:**

Room #	Room Name	Qty
158	CLASSROOM	1
306	CLASSROOM	1

Room #	Room Name	Qty
207	ES SCIENCE	1

Room #	Room Name	Qty
246	CLASSROOM	1

# Bristol Forestville

## Bristol, CT

### FF and E Specifications by Item

**Item:** Table-Faculty - Adjustable Height

**Item Code:** T-5

**Manufacturer:** Izzy

**Total Quantity:** 10

**Model:** Rylee Table - ADA

**Category:** A-1

**Description:** Square Height Adjustable Table - plastiic laminate top with Clara profile urethane edge and Clara Pin-Set height adjustable legs.

**Dimensions:** 42"Wx42"Dx25"-32"H ADA clearance

**Finish:**  
 Frame: Izzy Silver  
 Plastic Laminate: Pearl Neutral L06  
 Edge: Urethane Plum Black S06



**Power / Data:**

Room #	Room Name	Qty
119A	TEACHER PLANNING	2
233	FACULTY DINING	3

Room #	Room Name	Qty
134	CUSTODIAN STORAGE	1
249	TEACHER WORKROOM	2

Room #	Room Name	Qty
162A	TEACHERS PLANNING	2

# Bristol Forestville

## Bristol, CT

### FF and E Specifications by Item

---

**Item:** Library Work Table

**Item Code:** T-6

**Manufacturer:** Izzy

**Total Quantity:** 14

**Model:** Clara Team 4044 - ADA

**Category:** A-1

**Description:** Team 4044 Table has a concave shape on 2 sides and convex on 2 sides. The table is adjustable height because it will serve kids from K-8 in the Media Center.  
.  
.



**Dimensions:** 44"Wx42"Dx Adjustable Height 25"-32"H ADA clearance

**Finish:** Frame: Izzy Silver  
Plastic Laminate: Pearl Neutral L06  
Edge: Urethane Plum Black S06

**Power / Data:** Grommet with Cover in Center, Silver

Room #	Room Name	Qty
100	MEDIA CENTER	14

Room #	Room Name	Qty
--------	-----------	-----

Room #	Room Name	Qty
--------	-----------	-----

**Bristol Forestville**  
**Bristol, CT**  
**FF and E Specifications by Item**

**Item:** Student Table-Adjustable Height

**Item Code:** T-8

**Manufacturer:** Smith System

**Total Quantity:** 8

**Model:** Interchange Activity Table - ADA

**Category:** C-2

**Description:** Rectangular Activity Table - 1 1/4" thick high density particle board double sided with .30" HPL surfaces and mechanically fastened 3/8" bumper T-mold edge. Tops are pre-drilled for leg set attachment and are supported by one or more 2"x3" channels with 4 breakovers for optimum strength. 1" increment height adjustable ellipse legs constructed of 16ga stems & inserts, 14ga cross braces & 12ga plates w/each leg height secured by two 3/8" set screws. Legs terminate with sock style glide caps and large fine tune adjustable leveling, hard floor type glides.



**Dimensions:** 24"Dx 60"Wx22"-34"H ADA clearance

**Finish:** Top: Plastic Laminate - Wilsonart Fusion Maple  
 Edge: Blueberry  
 Frame & Legs: Platinum

**Power / Data:**

Room #	Room Name	Qty
143	FAMILY RESOURCE ROOM	8

Room #	Room Name	Qty
--------	-----------	-----

Room #	Room Name	Qty
--------	-----------	-----

# Bristol Forestville

## Bristol, CT

### FF and E Specifications by Item

---

**Item:** Art Table **Item Code:** T-9

**Manufacturer:** Diversified Woodcraft **Total Quantity:** 7

**Model:** P7246M30N **Category:** C-2

**Description:** Plain Apron Table with Maple Legs & Aprons and Epoxy Top. Steel reinforced construction.

**Dimensions:** 72"Wx36"Dx30"H

**Finish:** Legs & Apron: Maple  
Top" Black Epoxy



**Power / Data:**

Room #	Room Name	Qty
121	ELEMENTARY ART ROOM	7

Room #	Room Name	Qty
--------	-----------	-----

Room #	Room Name	Qty
--------	-----------	-----

# Bristol Forestville

## Bristol, CT

### FF and E Specifications by Item

**Item:** Waste Basket

**Item Code:** W-1

**Manufacturer:** Rubbermaid

**Total Quantity:** 97

**Model:** 4850

**Category:** Z

**Description:**

**Dimensions:** Note: Confirm size for millwork trash receptacle area

**Finish:**

**Power / Data:**

Room #	Room Name	Qty
100	MEDIA CENTER	1
101	ASSISTANT COUNCELOR	1
104	PSYCH.	1
107A	COPY	1
110	KITCHEN	1
114	FILE ROOM	1
117	COMPUTER ROOM	1
124	CLASSROOM	1
127	CLASSROOM	1
132	SMALL GROUP	1
135	CLASSROOM	1
138	CLASSROOM	1
143B	OFFICE	1
146	MIDDLE SCHOOL MUSIC	1
148J	PRACTICE	1
154	CLASSROOM	1
160	CLASSROOM	1
163B	MS RESTING	1

Room #	Room Name	Qty
100A	CIRCULATION	2
102	CONFERENCE ROOM	1
105	GUIDANCE COUNCELOR	1
108	CONFERENCE ROOM	1
111	AP	1
116A	ES ISS	1
121	ELEMENTARY ART ROOM	1
125	CLASSROOM	1
130	OT/PT	1
133	SMALL GROUP	1
136	CLASSROOM	1
139	CLASSROOM	1
144	ELEMENTARY SCHOOL MUSIC	1
148C	OFFICE	1
151	DANCE/DRAMA ROOM	1
157	HEALTH	1
161	CLASSROOM	1
163C	NURSE ADMIN.	2

Room #	Room Name	Qty
100C	LITERACY	1
103	PSYCH.	1
107	ADMINISTRATION	2
109	PRINCIPAL	1
112	AP	1
116B	MS ISS	1
123	CLASSROOM	1
126	CLASSROOM	1
131	SMALL GROUP	1
134	CUSTODIAN STORAGE	1
137	CLASSROOM	1
143	FAMILY RESOURCE ROOM	1
145A	MUSIC STORAGE	1
148E	OFFICE	1
153	CLASSROOM	1
158	CLASSROOM	1
162A	TEACHERS PLANNING	1
163D	ES RESTING	1

**Bristol Forestville**  
**Bristol, CT**  
**FF and E Specifications by Item**

163E	EXAM	1
167	OFFICE	1
211	CLASSROOM	1
214	CLASSROOM	1
217	CLASSROOM	1
223	CLASSROOM	1
226	CLASSROOM	1
229	CLASSROOM	1
240	CLASSROOM	1
246	CLASSROOM	1
251	SMALL GROUP 1	1
254	WORLD LANGUAGE	1
306	CLASSROOM	1
204	SMALL GROUP 4	1

163F	OFFICE	1
205	SMALL GROUP 5	1
212	CLASSROOM	1
215	CLASSROOM	1
219	ES SPECIAL ED	1
224	CLASSROOM	1
227	CLASSROOM	1
231	CLASSROOM	1
241	CLASSROOM	1
248	CLASSROOM	1
252	SMALL GROUP 2	1
302	CLASSROOM	1
308	CLASSROOM	1

163G	EXAM	1
209	CLASSROOM	1
213	CLASSROOM	1
216	CLASSROOM	1
221	CLASSROOM	1
225	CLASSROOM	1
228	CLASSROOM	1
234A	OFFICE	1
245	MIDDLE SCHOOL ART ROOM	1
250	CLASSROOM	1
253	SMALL GROUP 3	1
303	CLASSROOM	1
309	CLASSROOM	1

**Bristol Forestville**  
**Bristol, CT**  
**FF and E Specifications by Item**

**Item:** Trash Barrel with Lid and Dolly

**Item Code:** W-2

**Manufacturer:** Rubbermaid

**Total Quantity:** 5

**Model:** 50 Gal Brute Rollout Container

**Category:** Z

**Description:** RUBBERMAID 9W27 BRUTE® Rollout Container with Lid. Heavy-duty 8" wheels, attached hinged lid swings back and locks, Tough Dru-x construction. Rounded corners and smooth contours for cleanability. Molded in axle retainer.



**Dimensions:** Length: 28 1/2 in 72.4 cm Width: 23 3/8 in 59.4 cm Height: 36 1/2 in 92.7 cm

**Finish:** Grey

**Power / Data:**

Room #	Room Name	Qty
134	CUSTODIAN STORAGE	1
230	CUSTODIAN	1

Room #	Room Name	Qty
128	CUSTODIAN	1
310	CUSTODIAN	1

Room #	Room Name	Qty
160A	CUSTODIAN	1

**Bristol Forestville**  
**Bristol, CT**  
**FF and E Specifications by Item**

**Item:** Trash Barrel with Lid and Dolly

**Item Code:** W-3

**Manufacturer:** Rubbermaid

**Total Quantity:** 8

**Model:** 2632/2631/2640

**Category:** Z

**Description:** RUBBERMAID 2632 BRUTE® Container with lid and dolly. All-plastic, professional-grade construction will not rust, chip or peel; resists dents. Strong, snap-on lids are available for secure, stable stacking. Reinforced rims add strength and durability. Built-in handles allow easy, non-slip lifting and anti-jam nesting. Double-ribbed base increases stability and dragging capacity. Lid snaps on 32 gal container. Brute Dolly has 5 locking swivel casters holds up to 350 lb



**Dimensions:** Barrel: 32 Gal, 22" dia, 27 1/4"h, Dolly: 6 5/8"h 18 1/4"dia

**Finish:** Gray

**Power / Data:**

Room #	Room Name	Qty
121	ELEMENTARY ART ROOM	4

Room #	Room Name	Qty
245	MIDDLE SCHOOL ART ROOM	3

Room #	Room Name	Qty
245A	ART STORAGE	1

# Bristol Forestville

## Bristol, CT

### FF and E Specifications by Item

**Item:** Recycling Bin Blue

**Item Code:** WR-1

**Manufacturer:** Rubbermaid

**Total Quantity:** 97

**Model:** 2956-73

**Category:** Z

**Description:** Medium Deskside container with recycling logo. Contains post consumer recycled resin exceeding EPA guidelines

**Dimensions:** 14.4"l x 10 1/4"w x 15"h 28 1/8 qt

**Finish:** Blue with recycling logo

**Power / Data:**



Room #	Room Name	Qty
100	MEDIA CENTER	1
101	ASSISTANT COUNCELOR	1
104	PSYCH.	1
107A	COPY	1
110	KITCHEN	1
114	FILE ROOM	1
117	COMPUTER ROOM	1
124	CLASSROOM	1
127	CLASSROOM	1
132	SMALL GROUP	1
135	CLASSROOM	1
138	CLASSROOM	1
143B	OFFICE	1
146	MIDDLE SCHOOL MUSIC	1
148J	PRACTICE	1
154	CLASSROOM	1
160	CLASSROOM	1

Room #	Room Name	Qty
100A	CIRCULATION	2
102	CONFERENCE ROOM	1
105	GUIDANCE COUNCELOR	1
108	CONFERENCE ROOM	1
111	AP	1
116A	ES ISS	1
121	ELEMENTARY ART ROOM	1
125	CLASSROOM	1
130	OT/PT	1
133	SMALL GROUP	1
136	CLASSROOM	1
139	CLASSROOM	1
144	ELEMENTARY SCHOOL MUSIC	1
148C	OFFICE	1
151	DANCE/DRAMA ROOM	1
157	HEALTH	1
161	CLASSROOM	1

Room #	Room Name	Qty
100C	LITERACY	1
103	PSYCH.	1
107	ADMINISTRATION	2
109	PRINCIPAL	1
112	AP	1
116B	MS ISS	1
123	CLASSROOM	1
126	CLASSROOM	1
131	SMALL GROUP	1
134	CUSTODIAN STORAGE	1
137	CLASSROOM	1
143	FAMILY RESOURCE ROOM	1
145A	MUSIC STORAGE	1
148E	OFFICE	1
153	CLASSROOM	1
158	CLASSROOM	1
162A	TEACHERS PLANNING	1

**Bristol Forestville**  
**Bristol, CT**  
**FF and E Specifications by Item**

163B	MS RESTING	1
163E	EXAM	1
167	OFFICE	1
211	CLASSROOM	1
214	CLASSROOM	1
217	CLASSROOM	1
223	CLASSROOM	1
226	CLASSROOM	1
229	CLASSROOM	1
240	CLASSROOM	1
246	CLASSROOM	1
251	SMALL GROUP 1	1
254	WORLD LANGUAGE	1
306	CLASSROOM	1
204	SMALL GROUP 4	1

163C	NURSE ADMIN.	2
163F	OFFICE	1
205	SMALL GROUP 5	1
212	CLASSROOM	1
215	CLASSROOM	1
219	ES SPECIAL ED	1
224	CLASSROOM	1
227	CLASSROOM	1
231	CLASSROOM	1
241	CLASSROOM	1
248	CLASSROOM	1
252	SMALL GROUP 2	1
302	CLASSROOM	1
308	CLASSROOM	1

163D	ES RESTING	1
163G	EXAM	1
209	CLASSROOM	1
213	CLASSROOM	1
216	CLASSROOM	1
221	CLASSROOM	1
225	CLASSROOM	1
228	CLASSROOM	1
234A	OFFICE	1
245	MIDDLE SCHOOL ART ROOM	1
250	CLASSROOM	1
253	SMALL GROUP 3	1
303	CLASSROOM	1
309	CLASSROOM	1

# Bristol Forestville

## Bristol, CT

### FF and E Specifications by Item

**Item:** Large Recycling Bin Blue w/Dolly

**Item Code:** WR-2

**Manufacturer:** Rubbermaid

**Total Quantity:** 5

**Model:** 9W27-73

**Category:** Z

**Description:** Rubbermaid Brute Recycling rollout container with lid. Contains post consumer recycled resin exceeding EPA guidelines. Heavy-duty wheels, moulded in axil, 8" wheels.

**Dimensions:** 28 1/2"l x 23.4 w x 36 1/2"h

**Finish:** Blue with recycling logo, black lid.

**Power / Data:**



Room #	Room Name	Qty
134	CUSTODIAN STORAGE	1
230	CUSTODIAN	1

Room #	Room Name	Qty
128	CUSTODIAN	1
310	CUSTODIAN	1

Room #	Room Name	Qty
160A	CUSTODIAN	1

**Bristol Forestville**  
**Bristol, CT**  
**FF and E Specifications by Item**

**Item:** Steel Print Rack

**Item Code:** A-4

**Manufacturer:** Richeson

**Total Quantity:** 1

**Model:** DickBlick #51328-2005

**Category:** D

**Description:** Heavy-duty black steel print rack holds a large volume of matted or mounted artwork in a minimal amount of space. It is mobile with four casters and holds artwork up to 30" H x 40" W.



**Dimensions:** 34"Wx22"Dx32"H

**Finish:** Color: Black

**Power / Data:**

Room #	Room Name	Qty
245	MIDDLE SCHOOL ART ROOM	1

Room #	Room Name	Qty
--------	-----------	-----

Room #	Room Name	Qty
--------	-----------	-----

**Bristol Forestville**  
**Bristol, CT**  
**FF and E Specifications by Item**

**Item:** Mobile Storage Cart

**Item Code:** A-7

**Manufacturer:** Alvin

**Total Quantity:** 1

**Model:** DickBlick #51291-7506

**Category:** D

**Description:** 6 Drawer Mobile Storage Cart - with 4 standard size and 2 deep drawers.

**Dimensions:** 13"Wx15.5"Dx26"H

**Finish:** Color: Multi Color

**Power / Data:**



Room #	Room Name	Qty
245	MIDDLE SCHOOL ART ROOM	1

Room #	Room Name	Qty
--------	-----------	-----

Room #	Room Name	Qty
--------	-----------	-----

**Bristol Forestville**  
**Bristol, CT**  
**FF and E Specifications by Item**

**Item:** Area Rug **Item Code:** AR-2  
**Manufacturer:** Carpets for Kids **Total Quantity:** 5  
**Model:** School Specialty #6-679223-258 **Category:** D  
**Description:** 2nd Grade - Carpets for Kids - Colorful Places Seating Rectangular Rug  
**Dimensions:** 7'-6"x12' Rectangle  
**Finish:** Color: Multicolor  
**Power / Data:**



Room #	Room Name	Qty
221	CLASSROOM	1
225	CLASSROOM	1

Room #	Room Name	Qty
223	CLASSROOM	1
226	CLASSROOM	1

Room #	Room Name	Qty
224	CLASSROOM	1

**Bristol Forestville**  
**Bristol, CT**  
**FF and E Specifications by Item**

**Item:** Area Rug **Item Code:** AR-3  
**Manufacturer:** Carpets for Kids **Total Quantity:** 4  
**Model:** School Specialty #6-076246-258 & #6-066924-258 **Category:** D  
**Description:** 3rd Grade - Carpets for Kids - Rectangular Calendar Rug & Numbers Kit  
**Dimensions:** 7'-6"x12' Rectangle  
**Finish:** Color: Multicolor  
**Power / Data:**



Room #	Room Name	Qty
227	CLASSROOM	1
231	CLASSROOM	1

Room #	Room Name	Qty
228	CLASSROOM	1

Room #	Room Name	Qty
229	CLASSROOM	1

# Bristol Forestville

## Bristol, CT

### FF and E Specifications by Item

**Item:** Area Rug **Item Code:** AR-4

**Manufacturer:** Lakeshore Classroom Carpets **Total Quantity:** 4

**Model:** LC161 **Category:** D

**Description:** 4th Grade - Comfy Classroom Carpets made of thick, soil-resistant synthetic fiber.  
Passes Class II rating of NFPA 253 and meets the fire-resistance standards of the Uniform Building Code.



**Dimensions:** 6'x9' Rectangle

**Finish:** Color: Navy Blue

**Power / Data:**

Room #	Room Name	Qty
209	CLASSROOM	1
213	CLASSROOM	1

Room #	Room Name	Qty
211	CLASSROOM	1

Room #	Room Name	Qty
212	CLASSROOM	1

# Bristol Forestville

## Bristol, CT

### FF and E Specifications by Item

**Item:** Area Rug **Item Code:** AR-5

**Manufacturer:** Lakeshore Classroom Carpets **Total Quantity:** 4

**Model:** LC161 **Category:** D

**Description:** 5th Grade - Comfy Classroom Carpets made of thick, soil-resistant synthetic fiber.  
Passes Class II rating of NFPA 253 and meets the fire-resistance standards of the Uniform Building Code.



**Dimensions:** 6'x9' Rectangle

**Finish:** Color: Navy Blue

**Power / Data:**

Room #	Room Name	Qty
214	CLASSROOM	1
217	CLASSROOM	1

Room #	Room Name	Qty
215	CLASSROOM	1

Room #	Room Name	Qty
216	CLASSROOM	1

# Bristol Forestville

## Bristol, CT

### FF and E Specifications by Item

---

**Item:** MS Art Bench (Stool)

**Item Code:** C-8

**Manufacturer:** ShainSolutions

**Total Quantity:** 28

**Model:** AB

**Category:** C-2

**Description:** Wood seating bench with shelf stretcher.

**Dimensions:** 17"Wx12"Dx17"H

**Finish:** Wood: Clear Solid Maple

**Power / Data:**



Room #	Room Name	Qty
245	MIDDLE SCHOOL ART ROOM	28

Room #	Room Name	Qty
--------	-----------	-----

Room #	Room Name	Qty
--------	-----------	-----

# Bristol Forestville

## Bristol, CT

### FF and E Specifications by Item

---

**Item:** Art Pedestal Table

**Item Code:** T-11

**Manufacturer:** Shain Solutions

**Total Quantity:** 7

**Model:** PT-62M

**Category:** C-2

**Description:** Trestle Table w/1 3/4" Solid Maple top, base constructed of two tapered solid maple pedestal style legs, two solid maple truss bar feet with leveling leveling glides.



**Dimensions:** 60"Wx42"Dx30"H - ADA Clearance

**Finish:** UV Finished Solid Hardwood Maple

**Power / Data:**

Room #	Room Name	Qty
245	MIDDLE SCHOOL ART ROOM	7

Room #	Room Name	Qty
--------	-----------	-----

Room #	Room Name	Qty
--------	-----------	-----

# Bristol Forestville

## Bristol, CT

### FF and E Specifications by Item

---

**Item:** XL Art Pedestal Table

**Item Code:** T-12

**Manufacturer:** Shain Solutions

**Total Quantity:** 1

**Model:** PT-7248M

**Category:** C-2

**Description:** Trestle-Style Table w/1 3/4" Solid Maple top, base constructed of two tapered solid maple pedestal style legs, two solid maple truss bar feet with leveling leveling glides.



**Dimensions:** 72"Wx48"Dx36"H

**Finish:** UV Finished Solid Hardwood Maple

**Power / Data:**

Room #	Room Name	Qty
245	MIDDLE SCHOOL ART ROOM	1

Room #	Room Name	Qty
--------	-----------	-----

Room #	Room Name	Qty
--------	-----------	-----

# Bristol Forestville

## Bristol, CT

### FF and E Specifications by Item

---

**Item:** Work Bench

**Item Code:** T-13

**Manufacturer:** Shain Solutions

**Total Quantity:** 7

**Model:** WX4-M - ADA

**Category:** C-2

**Description:** Square Solid Maple Table with 2 1/4" maple legs with adjustable floor glides and solid maple apron with 13gauge steel corner braces.

**Dimensions:** 48"Wx48"Dx30"H ADA Accessible

**Finish:** UV Finished Solid Hardwood Maple

**Power / Data:**



Room #	Room Name	Qty
238	ENGINEERING TECH LAB	7

Room #	Room Name	Qty
--------	-----------	-----

Room #	Room Name	Qty
--------	-----------	-----

# Bristol Forestville

## Bristol, CT

### FF and E Specifications by Item

**Item:** Cafeteria Table - Elementary

**Item Code:** T-14

**Manufacturer:** Sico

**Total Quantity:** 14

**Model:** Graduate - 27"H

**Category:** F

**Description:** Round (Oval) Shaped Cafeteria Table w/8 Stools - with HPL Table top, & ABS stool seats, Armor-Edge hermetically sealed edges, powdercoated tubular steel frame, easy to operate folding mechanism and locking hard floor casters. 15 year warranty on Sico components, lifetime warranty on welds.

**Dimensions:** 60"W"x54"Dx27"H

**Finish:**  
 Frame: Std hexavalent nickle chrome  
 Top: P-Lam (HPL) -Wilsonart #7909-60 Fusion Maple  
 Edge: Gray Armor Edge  
 Stools: ABS Blue Ridge



**Power / Data:**

Room #	Room Name	Qty
232	CAFETERIA	14

Room #	Room Name	Qty
--------	-----------	-----

Room #	Room Name	Qty
--------	-----------	-----

# Bristol Forestville

## Bristol, CT

### FF and E Specifications by Item

**Item:** Cafeteria Table - Middle School

**Item Code:** T-15

**Manufacturer:** Sico

**Total Quantity:** 13

**Model:** Graduate - 29"H

**Category:** F

**Description:** Round (Oval) Shaped Cafeteria Table w/8 Stools - with HPL Table top, & ABS stool seats, Armor-Edge hermetically sealed edges, powdercoated tubular steel frame, easy to operate folding mechanism and locking hard floor casters. 15 year Warranty on sico components and lifetime warranty on welds.

**Dimensions:** 60"W"x54"Dx29"H

**Finish:**  
 Frame: Std hexavalent nickle chrome  
 Top: P-Lam (HPL) -Wilsonart 7909-60 Fusion Maple  
 Edge: Gray Armor Edge  
 Stools: ABS Blue Ridge #113



**Power / Data:**

Room #	Room Name	Qty
232	CAFETERIA	13

Room #	Room Name	Qty
--------	-----------	-----

Room #	Room Name	Qty
--------	-----------	-----

# Bristol Forestville

## Bristol, CT

### FF and E Specifications by Item

**Item:** Condiment Table

**Item Code:** T-25

**Manufacturer:** Sico

**Total Quantity:** 0

**Model:** Multi-App Table

**Category:** F

**Description:** Multi-App Table on Casters, Flip-top with pneumatic assist. HP laminate top with Armor-Edge®, Offset leg structure with perforated modesty panel. Units fold and nest. Warranty: 10 year on sico components and lifetime on welds. 3" dual-wheel swivel casters, locking.



**Dimensions:** 60"W x 24"D x 29"h

**Finish:** Frame: Powdercoat - Black  
Plastic Laminate: Wilsonart #7909-60 "Fusion Maple"

**Power / Data:**

Room #	Room Name	Qty
232	CAFETERIA	0

Room #	Room Name	Qty
--------	-----------	-----

Room #	Room Name	Qty
--------	-----------	-----

# Bristol Forestville

## Bristol, CT

### FF and E Specifications by Item

---

**Item:** Table - Rectangular

**Item Code:** T-26

**Manufacturer:** KI

**Total Quantity:** 6

**Model:** Inquire (ADA)

**Category:** L

**Description:** Rectangular Table with 4 legs and locking casters. Include 2 grommets, horizontal wire management and vertical wire management leg clips. Also include ganging latches on 2 sides.

**Dimensions:** 60"Wx24"Dx29"H ADA Clearance

**Finish:** Legs: Silver  
 Plastic Laminate: Wilsonart Fusion Maple  
 Edge: Warm Grey



**Power / Data:**

Room #	Room Name	Qty
238A	ENGINEERING COMPUTER LAB	6

Room #	Room Name	Qty
--------	-----------	-----

Room #	Room Name	Qty
--------	-----------	-----

# Bristol Forestville

## Bristol, CT

### FF and E Specifications by Item

**Item:** Table - Half Round

**Item Code:** T-27

**Manufacturer:** KI

**Total Quantity:** 3

**Model:** Inquire

**Category:** L

**Description:** Half Round Table with 4 legs and locking casters. Include 1 centered grommet, horizontal wire management and vertical wire management leg clips. Also include ganging latches on flat side.

**Dimensions:** 48"x24"x29"

**Finish:** Legs: Silver  
Plastic Laminate: Wilsonart Fusion Maple  
Edge: Warm Grey



**Power / Data:**

Room #	Room Name	Qty
238A	ENGINEERING COMPUTER LAB	3

Room #	Room Name	Qty
--------	-----------	-----

Room #	Room Name	Qty
--------	-----------	-----

**Bristol Forestville**  
**Bristol, CT**  
**FF and E Specifications by Item**

**Item:** Recycling & Waste Receptacle

**Item Code:** WR-4

**Manufacturer:** Peter Pepper

**Total Quantity:** 4

**Model:** 1035 - 32"H with 2 openings

**Category:** A-1

**Description:** Recycling & Waste Receptacle w/ optional fiberglass liners. Top Configuration: **TBD by Owner** with set of recycling decals, and identifiers

for Glass and Waste

**Dimensions:** 36"Wx16"Dx32"H 80 gallon capacity

**Finish:** Finish: Peter Pepper - Wheat  
 Decals: Black



**Power / Data:**

Room #	Room Name	Qty
232	CAFETERIA	3

Room #	Room Name	Qty
232A	VESTIBULE	1

Room #	Room Name	Qty
--------	-----------	-----

# Bristol Forestville

## Bristol, CT

### FF and E Specifications by Item

---

**Item:** Wheelchair  
**Manufacturer:** School Health  
**Model:** 10035

**Item Code:** N-6

**Total Quantity:** 1

**Category:** U

**Description:** The Traveler SE Wheelchair with 18" Wide Seat and Elevating Leg Rests. Everest & Jennings® wheelchair frame with saddle-joint tubular construction and the latest industry standard front rigging.

**Dimensions:** 18" w seat

**Finish:** Std. hammer tone finish

**Power / Data:**



Room #	Room Name	Qty
163G	EXAM	1

Room #	Room Name	Qty
--------	-----------	-----

Room #	Room Name	Qty
--------	-----------	-----

**Bristol Forestville**  
**Bristol, CT**  
**FF and E Specifications by Item**

**Item:** Mobile Side Table **Item Code:** N-7  
**Manufacturer:** School Health **Total Quantity:** 2  
**Model:** 24479 **Category:** U  
**Description:** 3- Drawer Cart with Key Lock, Steel construction with three lockable drawers, molded plastic top, swivel casters, (2) locking.  
**Dimensions:** 29" H x 13-1/4" D x 24-1/2" W  
 Drawer Size: 2-3/4"  
 Weight: 71 lbs.  
**Finish:** Beige (Std)  
**Power / Data:**



Room #	Room Name	Qty
163B	MS RESTING	1

Room #	Room Name	Qty
163D	ES RESTING	1

Room #	Room Name	Qty
--------	-----------	-----

# Bristol Forestville

## Bristol, CT

### FF and E Specifications by Item

---

**Item:** Waste Receptacle

**Item Code:** N-8

**Manufacturer:** School Health

**Total Quantity:** 5

**Model:** 24021

**Category:** U

**Description:** 21-Quart Square Can with foot pedal opening lid. All-steel construction. Unbreakable polyethylene inner pail.

**Dimensions:** 12" W x 13" L x 18-1/4" H

**Finish:** White (Std)



**Power / Data:**

Room #	Room Name	Qty
163A	TOILET	1
163E	EXAM	1

Room #	Room Name	Qty
163B	MS RESTING	1
163G	EXAM	1

Room #	Room Name	Qty
163D	ES RESTING	1

# Bristol Forestville

## Bristol, CT

### FF and E Specifications by Item

**Item:** Computer Table **Item Code:** T-22

**Manufacturer:** Smith System **Total Quantity:** 1

**Model:** UXL XL2460 AL & 17043 **Category:** C-2

**Description:** Computer Table with full width wire manager. 3/4" thick high density particle board double sided with .30" HPL surfaces and mechanically fastened 3/8" bumper T-mold edge. Straight - adjustable height steel tubular powder coated legs with glides.

**Dimensions:** 60"Wx24"DxAdj. 27"-33"H

**Finish:** Top: Plastic Laminate - Wilsonart Fusion Maple  
Edge: Platinum  
Frame & Legs: Platinum



**Power / Data:**

Room #	Room Name	Qty
117	COMPUTER ROOM	1

Room #	Room Name	Qty
--------	-----------	-----

Room #	Room Name	Qty
--------	-----------	-----

# Bristol Forestville

## Bristol, CT

### FF and E Specifications by Item

**Item:** Music Chair Tablet Arm **Item Code:** M-11

**Manufacturer:** Wenger **Total Quantity:** 45

**Model:** 939014 (qty 40) & 939015 (qty5) **Category:** I

**Description:** Folding Tablet Arm attachment to Music Posture Chairs 40 right hand tablet arms & 5 left hand tablet arms. Chairs do not stack with tablet arm units installed.

**Dimensions:** 15 1/2" from seat back to face of desk, 13 3/4"w x 17" l

**Finish:** Grey Pebble Laminate surface (std)



**Power / Data:**

Room #	Room Name	Qty
145A	MUSIC STORAGE	30

Room #	Room Name	Qty
146	MIDDLE SCHOOL MUSIC	15

Room #	Room Name	Qty
--------	-----------	-----

# Bristol Forestville

## Bristol, CT

### FF and E Specifications by Item

**Item:** Rolling Cart with 3 Shelves

**Item Code:** CT-1

**Manufacturer:** Edsal

**Total Quantity:** 7

**Model:** School Outfitters #EDS-OT2436-3

**Category:** Z

**Description:** Heavy 16-gauge steel mobile utility cart and 5" casters (2 fixed & 2 swivel).

**Dimensions:** 24"Wx36"Lx42"H

**Finish:** Powder coat: Color - Industrial Grey

**Power / Data:**



Room #	Room Name	Qty
141B	BOOK STORAGE	3
247	MIDDLE SCHOOL STORAGE	1

Room #	Room Name	Qty
156	STORAGE	1
305	STORAGE	1

Room #	Room Name	Qty
244	STORAGE	1

# Bristol Forestville

## Bristol, CT

### FF and E Specifications by Item

**Item:** Rolling Cart with 4 Shelves

**Item Code:** CT-2

**Manufacturer:** Edsal

**Total Quantity:** 8

**Model:** School Outfitters #EDS-OT2043-4

**Category:** Z

**Description:** Heavy 16-gauge steel mobile utility cart and 5" casters (2 fixed & 2 swivel).

**Dimensions:** 24"Wx43"Lx42"H

**Finish:** Powder coat: Color - Industrial Grey

**Power / Data:**



Room #	Room Name	Qty
128	CUSTODIAN	1
142	MAIN STORAGE	2
310	CUSTODIAN	1

Room #	Room Name	Qty
134	CUSTODIAN STORAGE	1
160A	CUSTODIAN	1

Room #	Room Name	Qty
141	STORAGE	1
230	CUSTODIAN	1

# Bristol Forestville

## Bristol, CT

### FF and E Specifications by Item

**Item:** Industrial Metal Shelving

**Manufacturer:** Penco Products

**Model:** Open Configuration

**Description:** Heavy Duty - Double Faced - 4 shelves high  
Open Steel Shelving

.

.

**Dimensions:** 120"Wx36"Dx 72"H Confirm 18" clearance from ceiling.

**Finish:** Color: Grey

**Power / Data:**

**Item Code:** SH-1

**Total Quantity:** 1

**Category:** B



Room #	Room Name	Qty
141B	BOOK STORAGE	1

Room #	Room Name	Qty
--------	-----------	-----

Room #	Room Name	Qty
--------	-----------	-----

# Bristol Forestville

## Bristol, CT

### FF and E Specifications by Item

---

**Item:** Industrial Metal Shelving  
**Manufacturer:** Penco Products  
**Model:** Open Configuration  
**Description:** Heavy Duty - Double Faced - 4 shelves high  
 Open Steel Shelving

**Item Code:** SH-2

**Total Quantity:** 1

**Category:** B



**Dimensions:** 144"Wx36"Dx72"H Confirm 18" clearance from ceiling.

**Finish:** Color: Grey

**Power / Data:**

Room #	Room Name	Qty
142	MAIN STORAGE	1

Room #	Room Name	Qty
--------	-----------	-----

Room #	Room Name	Qty
--------	-----------	-----

# Bristol Forestville

## Bristol, CT

### FF and E Specifications by Item

---

**Item:** Industrial Metal Shelving

**Manufacturer:** Penco Products

**Model:** Open Configuration

**Description:** Heavy Duty - Double Faced - 4 shelves high  
Open Steel Shelving

**Dimensions:** 120"Wx36"Dx72"H Confirm 18" clearance from ceiling.

**Finish:** Color: Grey

**Item Code:** SH-3

**Total Quantity:** 2

**Category:** B



**Power / Data:**

Room #	Room Name	Qty
142	MAIN STORAGE	2

Room #	Room Name	Qty
--------	-----------	-----

Room #	Room Name	Qty
--------	-----------	-----

# Bristol Forestville

## Bristol, CT

### FF and E Specifications by Item

**Item:** Area Rug **Item Code:** AR-6

**Manufacturer:** Carpets for Kids **Total Quantity:** 1

**Model:** School Specialty #6-679223-258 **Category:** D

**Description:** Elem. SPED Classroom - Carpets for Kids - Colorful Places Seating  
Rectangular Rug

**Dimensions:** 7'-6"x12' Rectangle

**Finish:** Color: Multicolor

**Power / Data:**



Room #	Room Name	Qty
219	ES SPECIAL ED	1

Room #	Room Name	Qty
--------	-----------	-----

Room #	Room Name	Qty
--------	-----------	-----

# Bristol Forestville

## Bristol, CT

### FF and E Specifications by Item

**Item:** Room Divider Screen

**Item Code:** SP-2

**Manufacturer:** Vanerum Stelter

**Total Quantity:** 2

**Model:** Custom Screen

**Category:** A-2

**Description:** Room dividing panel screen with tubular steel construction and opaque panel surfaces. Screen stands on one weighted steel disk and one locking caster.

**Dimensions:** 60"Wx48"Hx3"D

**Finish:** Steel: Powdercoat - Silver  
Perforated Panel: Color-TBS from full manufacturer's std color range.



**Power / Data:**

Room #	Room Name	Qty
219	ES SPECIAL ED	2

Room #	Room Name	Qty
--------	-----------	-----

Room #	Room Name	Qty
--------	-----------	-----

# Bristol Forestville

## Bristol, CT

### FF and E Specifications by Item

---

**Item:** Stool

**Item Code:** ST-2

**Manufacturer:** Columbia

**Total Quantity:** 26

**Model:** 0400

**Category:** C-2

**Description:** Adjustable height stool with chrome finished tubular steel legs and foot ring. Seat made with 5/8" melamine hard plastic. Standard Armor II Whisper Glides recommended for VCT



**Dimensions:** 17" - 24" Adjustable Height

**Finish:** Frame: Polished Chrome  
Color: Blue

**Power / Data:**

Room #	Room Name	Qty
238	ENGINEERING TECH LAB	26

Room #	Room Name	Qty
--------	-----------	-----

Room #	Room Name	Qty
--------	-----------	-----

# Bristol Forestville

## Bristol, CT

### FF and E Specifications by Item

**Item:** AV Cart w/Cabinet and Extendable Sh

**Item Code:** AV-2

**Manufacturer:** BUHL

**Total Quantity:** 2

**Model:** School Outfitters #BHL-SVCAB4226E

**Category:** D

**Description:** Adjustable Steel AV Cart with Cabinet and Extendable Shelf. Keep supplies secure in the lockable cabinet, and store your laptop close at hand on the pull-out side shelf. Rolls on four-inch casters.

**Dimensions:** 26"Wx18"Dx26-42"H (adjustable height)

**Finish:** Color: Charcoal

**Power / Data:** Include four-outlet surge protector with a 25-foot cord



Room #	Room Name	Qty
166	WORKROOM/ STORAGE	2

Room #	Room Name	Qty
--------	-----------	-----

Room #	Room Name	Qty
--------	-----------	-----

# Bristol Forestville

## Bristol, CT

### FF and E Specifications by Item

**Item:** Shelving Range - Mobile Double Face

**Item Code:** R-12

**Manufacturer:** MJ-3000 & Worden

**Total Quantity:** 3

**Model:** Shelving Range Semi-Custom Configuration

**Category:** G

**Description:** **Double Face Steel Cantilevered Shelves:**  
 Double face starter with (1) adder, 12 flat shelves (6 per side) w/integral backs, 1 sliding wire book support/shelf. Modify shelving units for semi-consealed locking casters.

**End Panels on Two Ends:**  
 1-1/4" Thick clear maple wood veneer end panel with solid clear maple hard wood eased edges, 1 1/4" wide @ vertical edges, 2" wide @ top edge, and 4" wide @ bottom edge.

**Canopy Top:** 1-1/4" Thick HPL face banded with 1-1/4" hard wood maple with eased edges on two long sides, brown backer under.

**Note:** Include all brackets and hardware for safe & secure installation. Provide letter from manufacturer re:safety and stability of rolling stacks as configured.



**Dimensions:** 75"Wx26"Dx42"H Overall nominal size of assembly Refer to Floor Plans V.I.F.

**Finish:** Steel Shelving: Powdercoat - Color- 2205 Light Gray  
 Wood End Panels and Edges: Clear Maple, Match Architect's Sample  
 Plastic Laminate Top: Wilsonart HPL, 10776-60 "Kensington Maple"

**Power / Data:**

Room #	Room Name	Qty
100	MEDIA CENTER	2

Room #	Room Name	Qty
100B	OPAC	1

Room #	Room Name	Qty
--------	-----------	-----

**Bristol Forestville**  
**Bristol, CT**  
**FF and E Specifications by Item**

**Item:** Round Occasional Table **Item Code:** T-19  
**Manufacturer:** KI **Total Quantity:** 4  
**Model:** Flex Round Occasional Table **Category:** L  
**Description:** Round Occasional Table with plastic laminate top and solid hardwood legs & edges  
**Dimensions:** 24"Diameter x 18"H  
**Finish:** Top: Plastic Laminate - Maple  
Wood Edges & Legs: Natural on Maple



**Power / Data:**

Room #	Room Name	Qty
101	ASSISTANT COUNCELOR	1

Room #	Room Name	Qty
106	RECEPTION	2

Room #	Room Name	Qty
109	PRINCIPAL	1

# Bristol Forestville

## Bristol, CT

### FF and E Specifications by Item

**Item:** Roller Shades **Item Code:** RS-1

**Manufacturer:** Draper **Total Quantity:** 5

**Model:** Manual FlexShade System **Category:** W

**Description:** Sun Filtering Roller Shades. Refer to Technical Specification Section 122413 Roller Shades. Inside mount with continuous headbox facia at window type 4. Clutch operator right hand operation with hold down at base. Orientation regular (from back of roller) install inside classroom.

**Dimensions:** Refer to 4/A11.3 door frame type 4  
Nominal dimentions: (5) 3'w x 7'h shades  
Field Verify all installation conditions.

**Finish:** PVC Free Shade Fabric: PW3500 series  
Color: PW3525 "Graystone" 5% openness factor  
Facia: White, Chain: Stainless steel bead.



**Power / Data:**

Room #	Room Name	Qty
144	ELEMENTARY SCHOOL MUSIC	5

Room #	Room Name	Qty
--------	-----------	-----

Room #	Room Name	Qty
--------	-----------	-----

**Bristol Forestville**  
**Bristol, CT**  
**FF and E Specifications by Item**

**Item:** Roller Shades **Item Code:** RS-2

**Manufacturer:** Draper **Total Quantity:** 3

**Model:** Manual FlexShade System **Category:** W

**Description:** Sun Filtering Roller Shades. Refer to Technical Specification Section 122413  
 Roller Shades. Outside mount above vision panel resess mount flush with ceiling

**Dimensions:** Refer to Vision Panel V2/A11.3  
 Nominal dimation 9'-10"w x 9'-0" height  
 Field Verify all installation conditions.

**Finish:** PVC Free Shade Fabric: PW3500 series  
 Color: PW3525 "Graystone" 5% opennness factor  
 Closure panel: White  
 Chain: Stainless steel bead.



**Power / Data:**

Room #	Room Name	Qty
108	CONFERENCE ROOM	3

Room #	Room Name	Qty
--------	-----------	-----

Room #	Room Name	Qty
--------	-----------	-----

**Bristol Forestville**  
**Bristol, CT**  
**FF and E Specifications by Item**

**Item:** Roller Shades **Item Code:** RS-3  
**Manufacturer:** Draper **Total Quantity:** 2  
**Model:** Manual FlexShade System **Category:** W  
**Description:** Sun Filtering Roller Shades. Refer to Technical Specification Section 122413 Roller Shades. Outside mount above vision panel, resess mount flush with ceiling. Center joint between shades on centerline of mullion. Set controls next to long panel on inside of conference room.  
**Dimensions:** Refer to Door Frame type 5/A11.3  
Nominal dimension (1) 3'-0"w x 9'-0"h, (1) 3'-0"w x 2'-0"h  
Field Verify all installation conditions.



**Finish:** PVC Free Shade Fabric: PW3500 series  
Color: PW3525 "Graystone" 5% openness factor  
Closure panel: White

**Power / Data:**

Room #	Room Name	Qty
102	CONFERENCE ROOM	2

Room #	Room Name	Qty
--------	-----------	-----

Room #	Room Name	Qty
--------	-----------	-----

# Bristol Forestville

## Bristol, CT

### FF and E Specifications by Item

**Item:** Lateral File - Custom **Item Code:** F-14

**Manufacturer:** KI **Total Quantity:** 4

**Model:** 700 Series Custom Built Lateral File **Category:** L

**Description:** Steel Lateral File - (2) 10 1/2" Drawers with hardware for front-to-back and side-to-side filing and (1) 7 1/2" Drawer with 2 sets of dividers, curve pulls, all drawers locking - key alike by room, and include counterbalance.

**Dimensions:** 42"Wx18"Dx31 9/16"H Outer Shell  
(3) Drawers as Specified

**Finish:** Steel Powdercoat: Light Tone  
Lock: Silver



**Power / Data:**

Room #	Room Name	Qty
100A	CIRCULATION	2

Room #	Room Name	Qty
100C	LITERACY	2

Room #	Room Name	Qty
--------	-----------	-----

# Bristol Forestville

## Bristol, CT

### FF and E Specifications by Item

**Item:** Book Truck

**Item Code:** L-2A

**Manufacturer:** Worden

**Total Quantity:** 3

**Model:** T-3016

**Category:** G

**Description:** Two sided wood book truck with 4 sloped and 1 flat shelf on 4 swivel casters.

—  
—

**Dimensions:** 30"Wx16"Dx38.5"H

**Finish:** Wood Finish: Maple

**Power / Data:**



Room #	Room Name	Qty
100A	CIRCULATION	1

Room #	Room Name	Qty
100C	LITERACY	1

Room #	Room Name	Qty
167	OFFICE	1

# Bristol Forestville

## Bristol, CT

### FF and E Specifications by Item

**Item:** Book Truck

**Item Code:** L-2B

**Manufacturer:** Worden

**Total Quantity:** 1

**Model:** Custom Similar to T-3016

**Category:** G

**Description:** One sided wood book truck with 2 sloped and 1 flat shelf on 4 swivel casters.

—

**Dimensions:** 30"Wx16"Dx38.5"H

**Finish:** Wood Finish: Maple

**Power / Data:**



Room #	Room Name	Qty
100A	CIRCULATION	1

Room #	Room Name	Qty
--------	-----------	-----

Room #	Room Name	Qty
--------	-----------	-----

# Bristol Forestville

## Bristol, CT

### FF and E Specifications by Item

**Item:** Rolling Cart with Top

**Item Code:** L-8A

**Manufacturer:** Smith System

**Total Quantity:** 1

**Model:** Anything Truck with Top

**Category:** C-2

**Description:** Steel, Double Face Mobile Cart w/ one shelf with six bins and two lower flat shelves with dual wheel, soft tread casters for quiet operation. 18ga steel tube frame and 20ga end panels, shelves & bins. - plastic laminate Top attached to handles.

**Dimensions:** 18"Dx36"Wx43"H

**Finish:** Steel Powdercoat: Platinum  
 Plastic Laminate: Fusion Maple  
 Edge: Platinum



**Power / Data:**

Room #	Room Name	Qty
166	WORKROOM/ STORAGE	1

Room #	Room Name	Qty
--------	-----------	-----

Room #	Room Name	Qty
--------	-----------	-----

# Bristol Forestville

## Bristol, CT

### FF and E Specifications by Item

**Item:** Rolling Cart **Item Code:** L-8B

**Manufacturer:** Smith System **Total Quantity:** 1

**Model:** Everything Cart **Category:** C-2

**Description:** Steel, Double Face Mobile Cart w/ two shelves each with six bins and with dual-wheel, soft tread casters for quiet operation. 18ga steel tube frame and 20ga end panels, shelves & bins.

**Dimensions:** 18"Dx36"Wx43"H

**Finish:** Steel Powdercoat: Platinum



**Power / Data:**

Room #	Room Name	Qty
166	WORKROOM/ STORAGE	1

Room #	Room Name	Qty
--------	-----------	-----

Room #	Room Name	Qty
--------	-----------	-----

# Bristol Forestville

## Bristol, CT

### FF and E Specifications by Item

**Item:** Cafeteria Table - Elementary ADA

**Item Code:** T-14A

**Manufacturer:** KI

**Total Quantity:** 1

**Model:** Portico Special-S11476980 ADA

**Category:** F

**Description:** Round Plastic Laminate Table with (3) T-22 Pin Height Adjustable Bases

**Dimensions:** 60"Diameter 27"-34" Adjustable Height ADA Accessible  
Set to 27"H (match height of T-15 unless otherwise required)

**Finish:** Plastic Laminate: Wilsonart Fusion Maple  
Edge: 74P Color Black  
Legs: Powder coat Black



**Power / Data:**

Room #	Room Name	Qty
232	CAFETERIA	1

Room #	Room Name	Qty
--------	-----------	-----

Room #	Room Name	Qty
--------	-----------	-----

# Bristol Forestville

## Bristol, CT

### FF and E Specifications by Item

**Item:** Cafeteria Table - Middle School - ADA

**Item Code:** T-15A

**Manufacturer:** KI

**Total Quantity:** 1

**Model:** Portico Special-S11476980 ADA

**Category:** F

**Description:** Round Plastic Laminate Table with (3) Adjustable T-Bases

**Dimensions:** 60"Diameter 27"-34" Adjustable Height ADA Accessible  
Set to 29"H (match height of T-15 unless otherwise required)

**Finish:** Plastic Laminate: Wilsonart Fusion Maple  
Edge: 74P Color: Black  
Legs: Powdercoat Black



**Power / Data:**

Room #	Room Name	Qty
232	CAFETERIA	1

Room #	Room Name	Qty
--------	-----------	-----

Room #	Room Name	Qty
--------	-----------	-----

# Bristol Forestville

## Bristol, CT

### FF and E Specifications by Item

**Item:** Cafeteria Table/Bench ADA

**Item Code:** T-14B

**Manufacturer:** Sico

**Total Quantity:** 24

**Model:** convertible - ADA

**Category:** F

**Description:** 3-in-1 ConverTable Table/Bench - with high pressure laminate table top & bench seat, Armor-Edge hermetically sealed edges, powdercoated 2 1/2"x1 1/8"oval tube steel frame, reduced caster beam length, increased seating capacity between leg supports, casters with front mounted wheel locks, easy to operate folding mechanisms, unit-to-unit connectors, and ADA access.



**Dimensions:** 72"Lx27"H ADA Clearance

**Finish:**  
 Legs/Frame: Powdercoat- Black  
 Top & Bench: P-Lam (HPL) Custom-Table Top Wilsonart 7909-60 Fusion Maple  
 Seat: HP Laminate Woolamai Brush 4746-60  
 Edge: black

**Power / Data:**

Room #	Room Name	Qty
232	CAFETERIA	24

Room #	Room Name	Qty
--------	-----------	-----

Room #	Room Name	Qty
--------	-----------	-----

# Bristol Forestville

## Bristol, CT

### FF and E Specifications by Item

**Item:** Student Wing Desk

**Item Code:** D-2B

**Manufacturer:** Smith Systems

**Total Quantity:** 8

**Model:** Wing - 03095 ADA

**Category:** C-2

**Description:** Triangular Shaped Desk w/out bookbox (confirm for elementary). with 3 fully welded elliptical leg components. The top plates are 14 gauge steel, each welded to a 14 gauge 1"x1" tube. A 16 gauge elliptical tube is welded to each top plate and each square tube for maximum durability. All three leg weldments are joined at the center by one connector bolt and nut pair. The entire assembly is fastened to the top with 12 fasteners. The pre-drilled top is 1 1/4" thick high density particle board double sided with .30" HPL work surface and mechanically fastened 3/8" Bumper T-mold edge. Legs terminate with sock style glide caps and large fine tune adjustable leveling, hard floor type glides.



**Dimensions:** 30"Wx30"D(41"on one side)x21.5-31.5" Adjustable Height - ADA Clearance

**Finish:** Top: Plastic Laminate - Wilsonart Fusion Maple  
Edge: Blueberry  
Frame & Legs: Platinum

**Power / Data:**

Room #	Room Name	Qty
124	CLASSROOM	2
127	CLASSROOM	2

Room #	Room Name	Qty
125	CLASSROOM	2

Room #	Room Name	Qty
126	CLASSROOM	2

# Bristol Forestville

## Bristol, CT

### FF and E Specifications by Item

**Item:** Safco 15 Drawer Steel Flat File

**Item Code:** F-15

**Manufacturer:** Safco

**Total Quantity:** 1

**Model:** (3)1363881 & (1) 1363889

**Category:** B

**Description:** (3) Large stacking Safco 5 -Drawer Steel Flat Files on closed base. Case-hardened ball-bearing rollers positive closures, rear hood and hinged front depressor.

**Dimensions:** 53 3/8"Wx413/8"D

**Finish:** Paint: TBS from manufacturers full color range.

**Power / Data:**



Room #	Room Name	Qty
134	CUSTODIAN STORAGE	1

Room #	Room Name	Qty
--------	-----------	-----

Room #	Room Name	Qty
--------	-----------	-----

# Bristol Forestville

## Bristol, CT

### FF and E Specifications by Item

---

**Item:** Shelving Range - Single Face **Item Code:** R-13A

**Manufacturer:** MJ-3000 & Worden **Total Quantity:** 1

**Model:** Shelving Range Semi-Custom Configuration **Category:** G

**Description:** **Single Face Steel Cantilevered Shelves:**  
 (1) 78"Hx30"Wx10"D Single face starter w/6 10"D integral back shelves per section, (5) 78"Hx36"Wx10"D single face adders w/6 10"D integral back shelves per section & 1 sliding wire book support/shelf.  
**End Panels on Two Ends**  
 1-1/4" Thick clear maple wood veneer end panel with solid clear maple hard wood eased edges, 1 1/4" wide @ vertical edges, 2" wide @ top edge, and 4" wide @ bottom edge.  
**Canopy Top:** 1-1/4" Thick HPL face banded with 1-1/4" hard wood maple with eased edges on two long sides, brown backer under.  
**Note:** Include all brackets and hardware for safe & secure installation.

**Dimensions:** 213"Wx12"Dx78"H Overall nominal size of assembly Refer to Floor Plans V.I.F.

**Finish:** Steel Shelving: Powdercoat - Color- 2205 Light Gray  
 Wood End Panels and Edges: Clear Maple, Match Architect's Sample  
 Plastic Laminate Top: Wilsonart 10776-60 "Kensington Maple"

**Power / Data:**

Room #	Room Name	Qty
100	MEDIA CENTER	1

Room #	Room Name	Qty
--------	-----------	-----

Room #	Room Name	Qty
--------	-----------	-----

# Bristol Forestville

## Bristol, CT

### FF and E Specifications by Item

---

**Item:** Shelving Range - Single Face **Item Code:** R-13B

**Manufacturer:** MJ-3000 & Worden **Total Quantity:** 1

**Model:** Shelving Range Semi-Custom Configuration **Category:** G

**Description:** **Single Face Steel Cantilevered Shelves:**  
 (1) 78"Hx30"Wx10"D Single face starter w/6 10"D integral back shelves, (4) 78"Hx36"Wx10"D single face adders w/6 10"D integral back shelves per section, (1) 78"Hx30"Wx10"D single face adder w/6 10"D integral back shelves & 1 sliding wire book support/shelf.  
**End Panels on Two Ends**  
 1-1/4" Thick clear maple wood veneer end panel with solid clear maple hard wood eased edges, 1 1/4" wide @ vertical edges, 2" wide @ top edge, and 4" wide @ bottom edge.  
**Canopy Top:** 1-1/4" Thick HPL face banded with 1-1/4" hard wood maple with eased edges on two long sides, brown backer under.  
**Note:** Include all brackets and hardware for safe & secure installation.

**Dimensions:** 207"Wx12"Dx78"H Overall nominal size of assembly Refer to Floor Plans V.I.F.

**Finish:** Steel Shelving: Powdercoat - Color- 2205 Light Gray  
 Wood End Panels and Edges: Clear Maple, Match Architect's Sample  
 Plastic Laminate Top: Wilsonart 10776-60 "Kensington Maple"

**Power / Data:**

Room #	Room Name	Qty
100	MEDIA CENTER	1

Room #	Room Name	Qty
--------	-----------	-----

Room #	Room Name	Qty
--------	-----------	-----