

# FENCE

## Bristol Bldg. Dept. Plot Plan Form

Draw Below:  
Location of existing house and proposed fence.  
Setback distance from fence to property lines.  
Size (length, height) Type (stockade, picket)  
Name of streets.

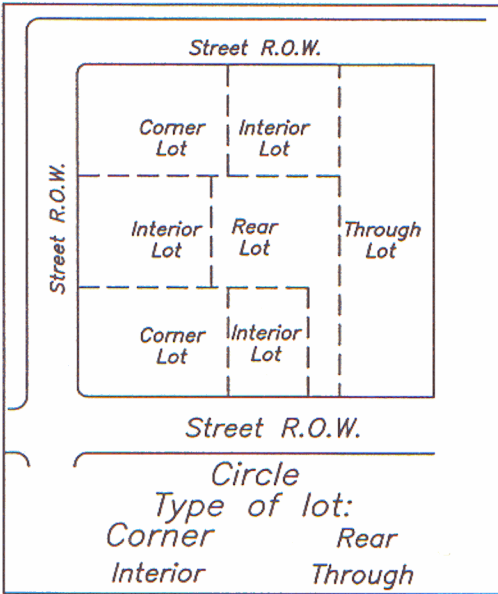

Sample Drawing Below

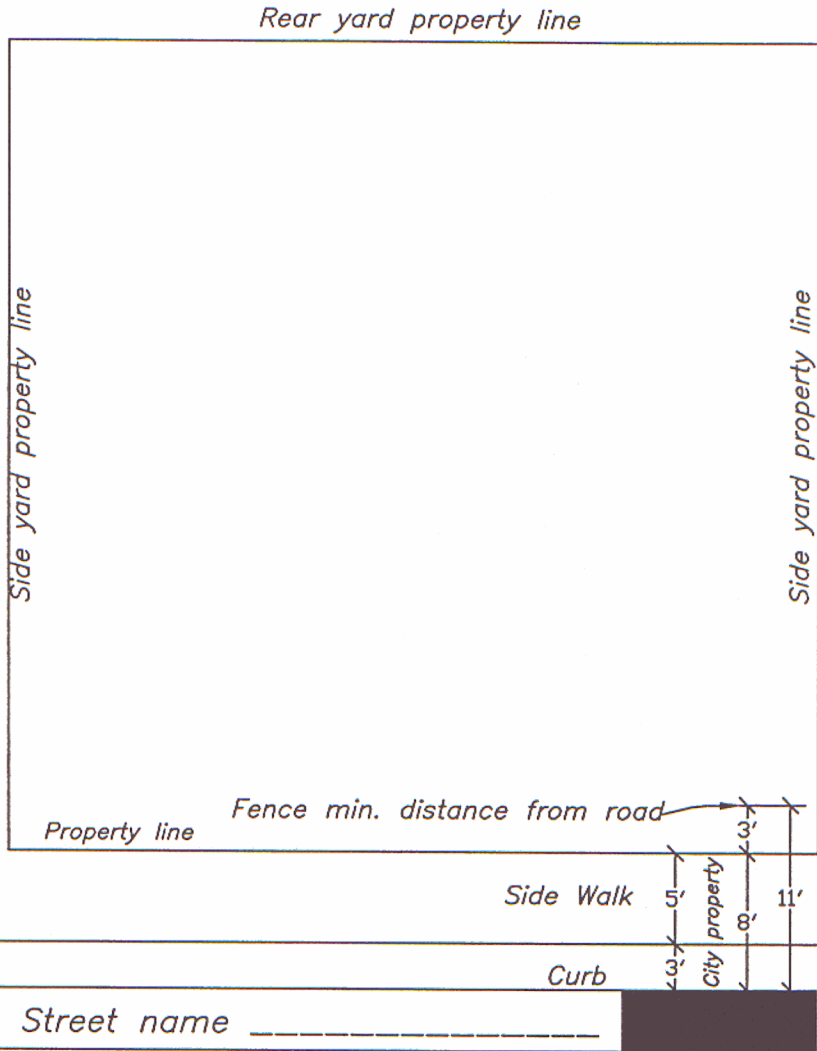
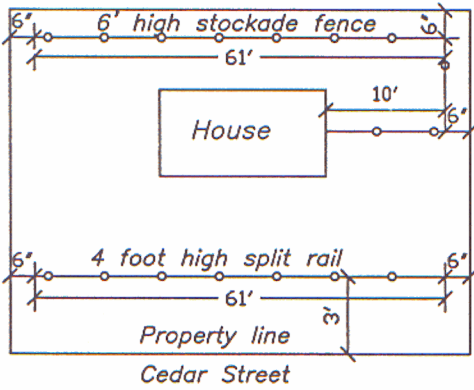

Street name if corner lot \_\_\_\_\_

Street name \_\_\_\_\_

No fence shall be erected closer than six (6) inches from any neighboring property line either side or rear yard. No fence shall be closer than three (3) feet to a street line. (Front property line)

Solid board, stockade or basket weave fences shall not be more than Six (6) feet in height. No fence shall be higher than forty eight (48) inches in a front yard. The fence must be uniformly less than 50 percent (%) solid with the finished side facing the neighbors.

The owner of the premises thereby confirms that the plot plan as submitted is correct to the best of his/her knowledge and conforms to Sec. 5-23 Fences of the City of Bristol Ordinances. If it is found that the fence location is not in conformity with the plot plan, it will be the owner's responsibility to move the fence to its proper location.

THIS FORM MUST ACCOMPANY THE BUILDING PERMIT APPLICATION FORM

Date \_\_\_\_\_ Signature \_\_\_\_\_

ADDRESS \_\_\_\_\_